

## SECTION 7

# REAR QUARTER

### INDEX

Subject	Page	Subject	Page
Description . . . . .	7-1	Window Assembly - "Z-37 & 67" Styles	
Inner Panel Sealing . . . . .	7-1	Removal and Installation . . . . .	7-12
Window Assembly - "A-27 & 77," "B-11" & "X-27" Styles. . . . .	7-2	Adjustments . . . . .	7-12
Window Adjustments - "A-27 & 77," "B-11" & "X-27" Styles. . . . .	7-3	Window Assembly - "B & C - 47, 57, 67 & 87" Styles	
Window Rear Glass Run Channel -		Description . . . . .	7-12
All Closed Styles . . . . .	7-3	Removal and Installation . . . . .	7-13
Window Front Glass Run Channel -		Adjustments . . . . .	7-14
All Closed Styles . . . . .	7-4	Window Regulator (Manual and Electric) -	
Window Outer Strip Assemblies -		"B & C - 47, 57, 67 & 87" Styles . . . . .	7-15
All Closed Styles . . . . .	7-4	Window Regulator (Manual and Electric) -	
Window Rear Vertical Inner Sealing Strip		"A, E, F & Z" Hardtop and Convertible Styles . . . . .	7-16
Assembly - "C-47" Styles . . . . .	7-5	Window Regulator (Manual and Electric) -	
Window Assembly - All Hardtop & Convertible		"A, B & X" Closed Styles . . . . .	7-17
Styles (Except "B & C" Series). . . . .	7-5	Window Regular (Manual and Electric) -	
Window Assembly - "A-37, 67 & 87" Styles		"A, B & X" Closed Styles . . . . .	7-17
Description . . . . .	7-5	Window Front Guide - "B-C 47-57-67-87"	
Removal and Installation . . . . .	7-5	Styles - Removal and Installation . . . . .	7-18
Adjustments . . . . .	7-7	Window Front Guide - "Z" Hardtop and	
Window Assembly - "F-37 & 67" Styles		Convertible and "E-87" Styles	
Removal and Installation . . . . .	7-7	Removal and Installation . . . . .	7-22
Adjustments . . . . .	7-7	Window Rear Guide - "Z" Hardtop and	
Window Assembly - "E-87" Styles		Convertible and "E-87" Styles	
Removal and Installation . . . . .	7-8	Removal and Installation . . . . .	7-22
Adjustments . . . . .	7-8	Window Guide Assembly - "A" Hardtop and	
Window Assembly - "E-47" Styles		Convertible Styles	
Removal and Installation . . . . .	7-9	Removal and Installation . . . . .	7-24
Adjustments . . . . .		Window Guide Assembly - "F" Styles	
		Removal and Installation . . . . .	7-24
		Window Glass Run Channel - "E-47" Styles	
		Removal and Installation . . . . .	7-24

### DESCRIPTION

Closed style rear quarter windows operate within glass run channels. Hardtop and convertible styles employ nylon rollers which are component parts of the lower sash channel or bolt directly to the glass. The nylon rollers operate within run channel guides which may vary dependent upon style.

All quarter glass is constructed of solid tempered safety plate. Caution must be applied when handling glass, as glass may shatter if it is chipped or scratched. Do Not attempt to grind or to drill glass.

When performing any service operations to the rear quarter window hardware, it is necessary to remove the rear quarter trim assembly (see Section 14).

### REAR QUARTER INNER PANEL SEALING

All rear quarter inner panels are sealed with one or a combination of water deflectors, access hole covers, sealing plugs (or grommets) and body

sealer. Service procedures for inner panel water deflectors are outlined in the "Front and Rear Door" section of this manual (see index). Figure 7-1 is typical of a water deflector installation.

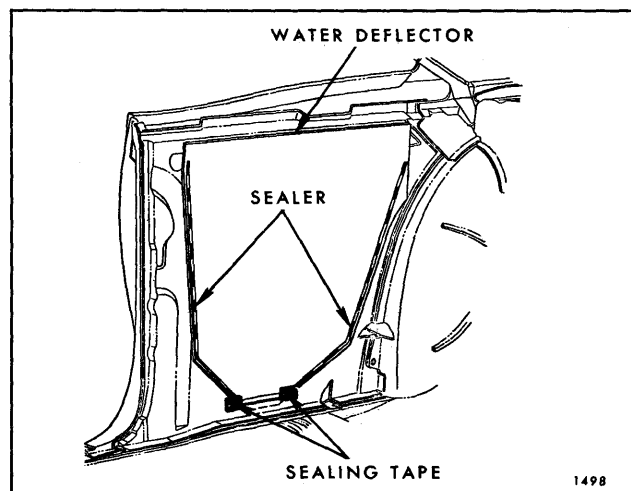

Fig. 7-1—Rear Quarter Inner Panel Sealing - Typical of Water Deflector Installation

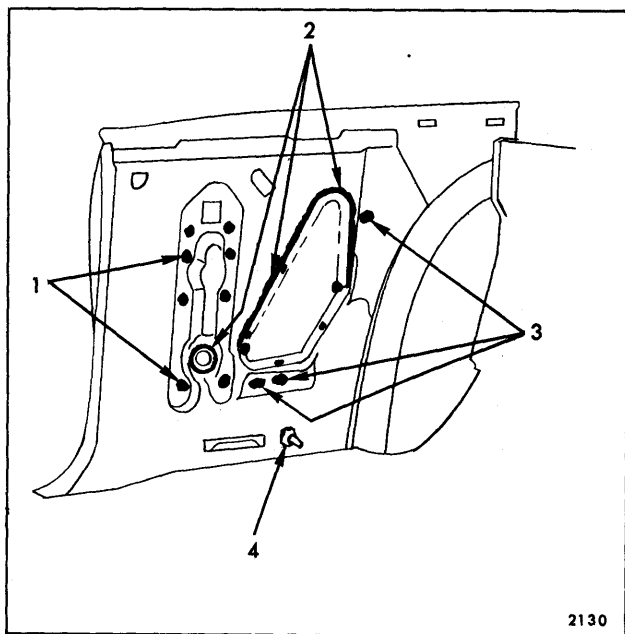

Fig. 7-2—Rear Quarter Inner Panel Sealing - "67" Styles

- |                                   |                                      |
|-----------------------------------|--------------------------------------|
| 1. Regulator Attaching Bolt Slots | 3. Window Guide Adjusting Stud Slots |
| 2. Access Hole Covers             | 4. Electrical Harness Grommet        |

Inner panel access hole covers are retained by screws and sealed with a non-hardening body

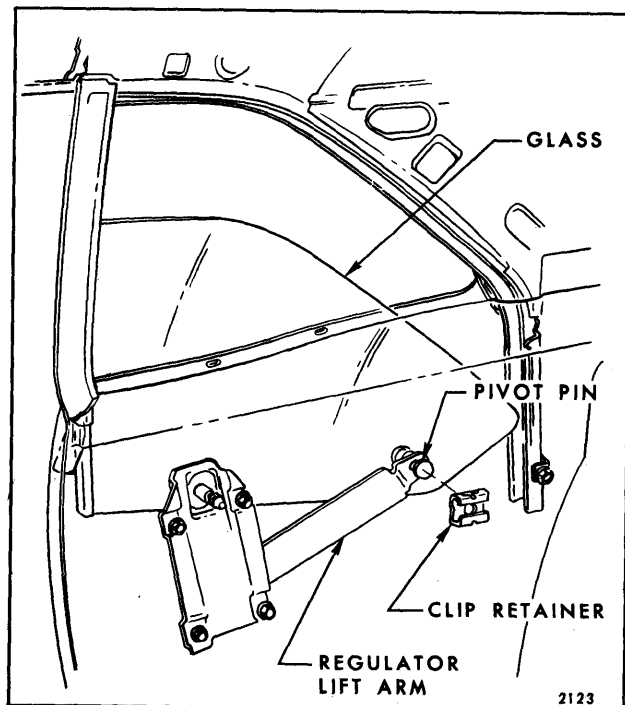

Fig. 7-3—Rear Quarter Window Attachment - "A" Closed Styles Shown - "X" Typical

sealer. Usually, removal of either the water deflector or access hole cover will provide the clearance required for service procedures of rear quarter hardware. Whenever any seal has been disturbed, however, the area must be carefully resealed to prevent waterleaks. Body caulking compound is recommended for service sealing. Figure 7-2 illustrates quarter inner panel sealing on styles which use individual seals at all hardware attaching locations.

## REAR QUARTER WINDOW "A-27-77 B-11 AND X-27" STYLES

### Removal and Installation

1. Remove rear quarter trim assembly and inner panel water deflector.
2. Operate window to position shown in Figure 7-3 for "A" and "X" styles, and Figure 7-4 for "B" styles.
3. Support glass with one hand and disengage clip retainer which secures regulator lift arm to pivot pin on window sash channel on "B-11" Styles (Fig. 7-5) or at lower edge of glass on "A" (Fig. 7-6) and "X" (Fig. 7-7) Styles.
4. Lower front edge of glass until nylon guide at top of window front vertical sash comes out of front glass channel and rear edge of glass

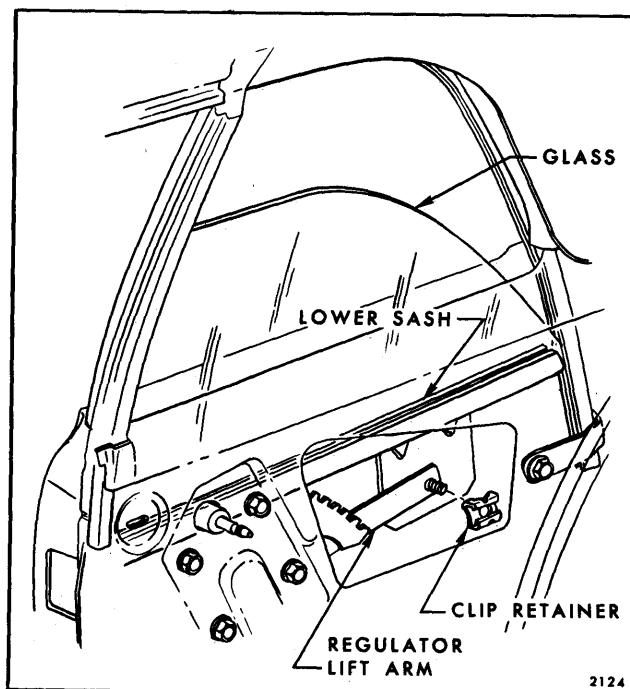

Fig. 7-4—Rear Quarter Window Attachment - "B-11" Styles

comes out of rear run channel. Then, lift glass up (rear edge first) and remove window from body outboard of window opening.

5. To install, reverse removal procedure.

## REAR QUARTER WINDOW "A-27-77 B-11 AND X-27" STYLES

### Adjustments

All window assembly adjustments are provided at the window regulator attaching screws.

1. To obtain proper seating of the glass in the upper glass run channels, or proper contact between belt sealing strips and lower sash channel, loosen regulator attaching screws and adjust window as required.
2. To eliminate a fore and aft bind between the glass run channels (hard operating window), or a condition where window will not stay in rear run channel, loosen rear run channel attaching

bolt and adjust run channel fore or aft as required.

## REAR QUARTER WINDOW REAR GLASS RUN CHANNEL—All Closed Styles

### Removal and Installation

1. Remove rear quarter window as previously described.
2. Remove run channel to inner panel attaching bolt (Fig. 7-8).
3. Remove screws securing run channel to side roof rail along length of run channel.
4. Using a flat-bladed tool, carefully pry run channel retaining clips from piercings in side roof rail.

**NOTE:** If difficulty is encountered disengaging run channel, inspect inside of channel for the presence of screws.

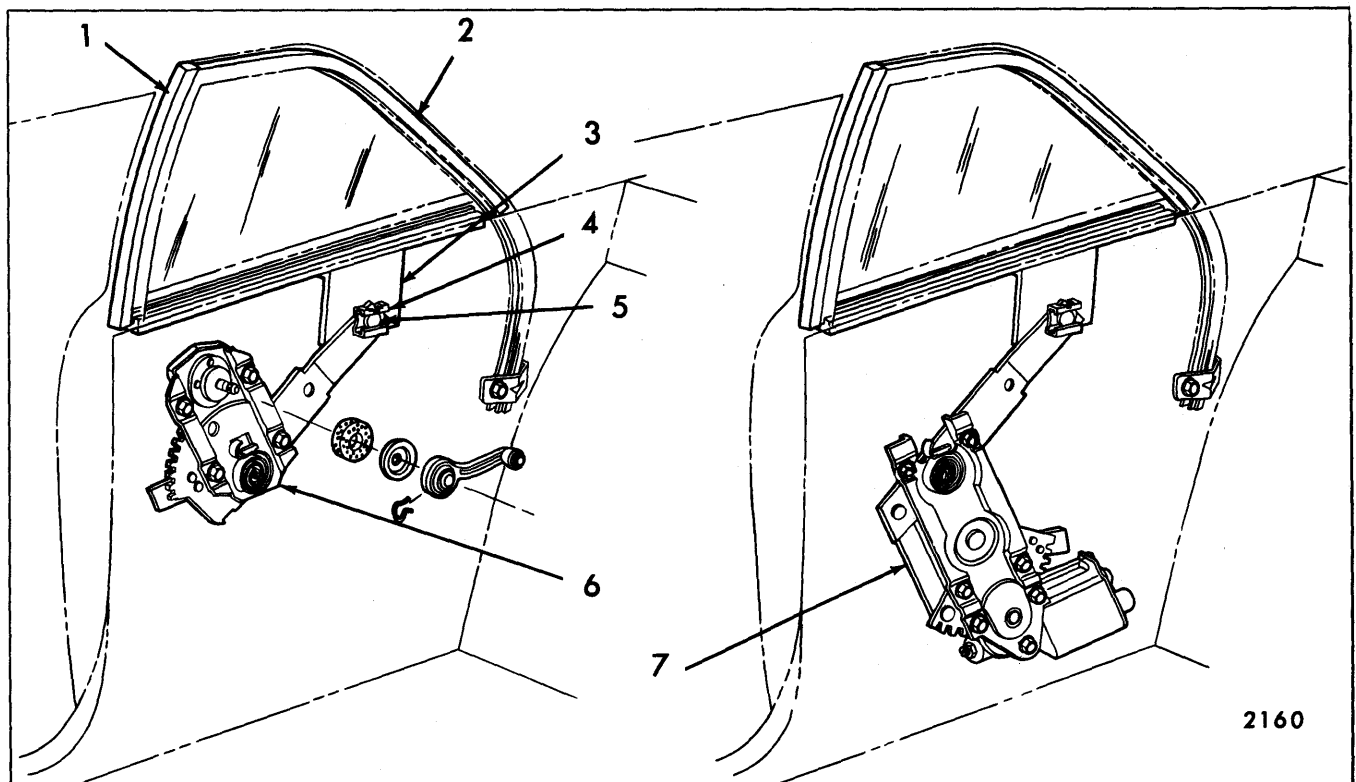

Fig. 7-5—Rear Quarter Hardware - "B-11" Styles

1. Front Glass Run Channel  
2. Rear Glass Run Channel

3. Window Lower Sash  
4. Clip Retainer

5. Pivot Pin  
6. Regulator (Manual)

7. Regulator (Electric)

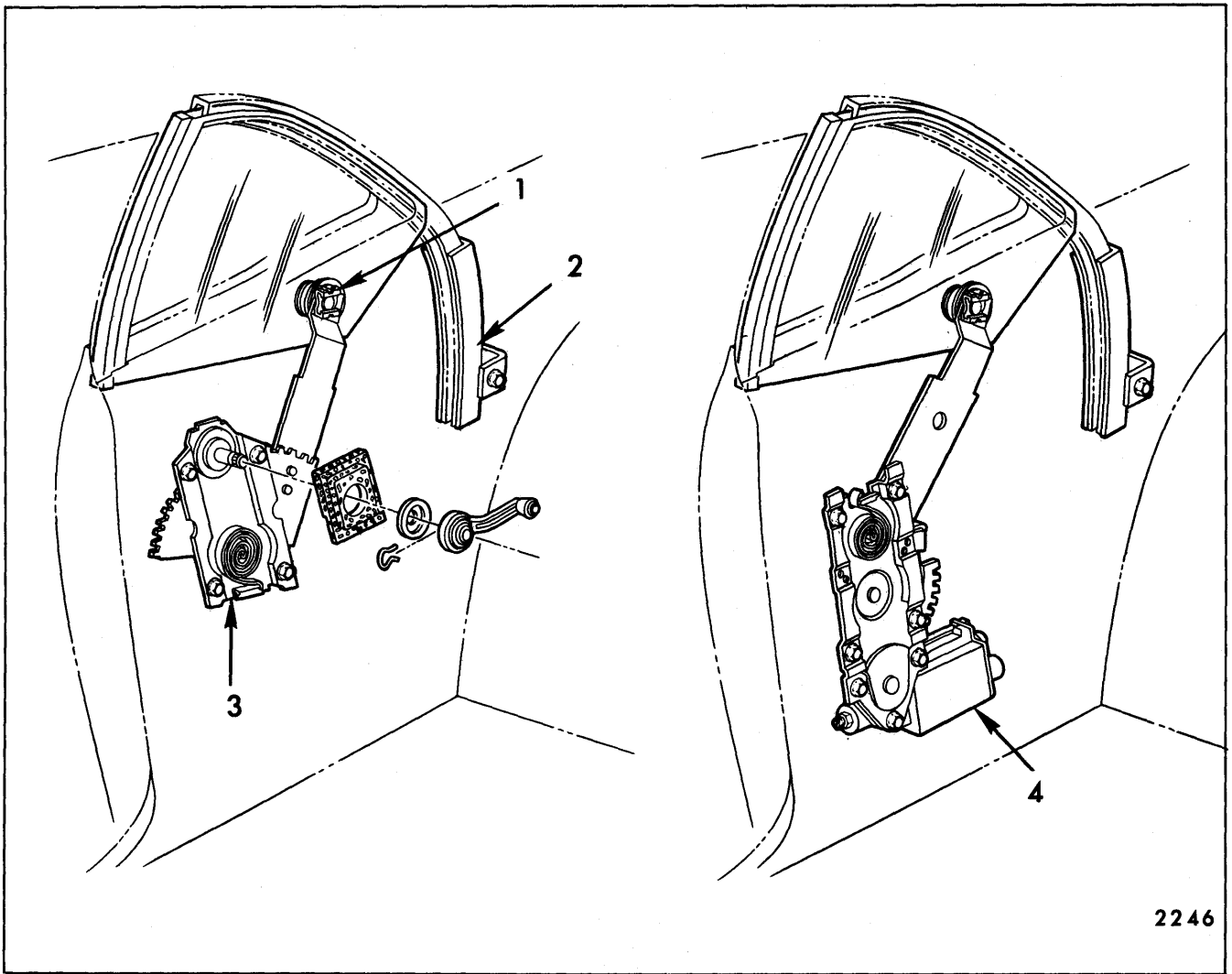

2246

Fig. 7-6—Rear Quarter Hardware - A - "27-77" Styles

1. Glass Retainer      2. Glass Run Channel      3. Window Regulator (Manual)      4. Window Regulator (Electric)

5. Prior to installation, inspect foam sealing material for any damage that would result in waterleaks, and replace as necessary.

6. To install, reverse removal procedure.

## REAR QUARTER WINDOW FRONT GLASS RUN CHANNEL—All Closed Styles

### Removal and Installation

1. Remove rear quarter window as previously described.
2. Remove screws along length of run channel securing channel to body (Figs. 7-7 and 7-8).

3. On all styles, using a flat bladed tool, pry run channel from body pillar and remove run channel (Fig. 7-9).

4. To install, reverse removal procedure. Prior to installation inspect sealing material on body pillar or run channel and replace or add to as required.

## REAR QUARTER WINDOW OUTER STRIP ASSEMBLY—All Closed Styles

1. Remove rear quarter trim assembly and inner panel water deflector.
2. Disengage window assembly from regulator lift

arm by removing slotted retainer (see Fig. 7-4).

3. Lower window assembly to bottom of rear quarter and rest it against outer panel.
4. On styles with screw retained strip assemblies, remove screws securing outer strip to rear quarter outer panel return flange and remove strip from body (see Fig. 7-10). On styles with clip retained strip assemblies, refer to index of "Door" section for removal procedure.

**NOTE:** Use care not to damage strip assembly or adjacent painted surfaces.

5. To install, reverse removal procedure.

### REAR QUARTER WINDOW REAR VERTICAL INNER SEALING STRIP ASSEMBLY—"C-47" Styles

The rear vertical inner sealing strip assembly serves as a glass run channel above the belt for the rear quarter window. As shown in Figure 7-11 the strip assembly is retained by clips which snap over the leading edge of the quarter inner upper panel. See Item 6 in Figure 7-12 for installed view of sealing strip.

To remove the strip assembly, it is necessary to remove the rear quarter trim assembly and the side roof rail rear finishing molding which covers the sealing strip clips.

### REAR QUARTER WINDOW ASSEMBLY—All Hardtop and Convertible Styles Except "B-C" Series

The rear quarter window is made of solid tempered safety plate glass. Consequently, it cannot be drilled or ground, or develop scratches or edge chips as it will shatter. The window assembly consists of a pressed-on front vertical sash channel and a bolt-on lower sash channel assembly.

**NOTE:** When reinstalling glass to sash channel bolts, or nylon roller nuts, torque to 72 inch pounds (6 foot pounds). Also, replace glass to sash channel spacers (rubber).

Various hardware illustrations are provided in this section to assist in performing any of the following procedures. To perform any of the procedures which follow, remove the rear quarter trim assembly and inner panel water deflector and/or access hole covers.

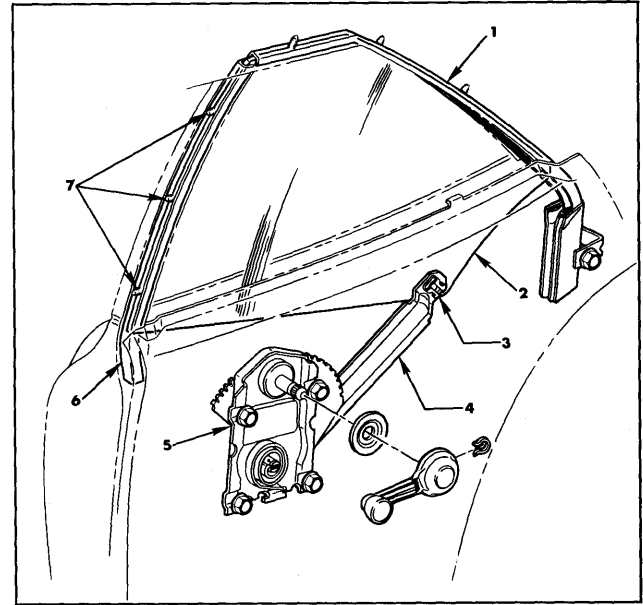

Fig. 7-7—Rear Quarter Hardware "X-27" Styles

- |                           |                                       |
|---------------------------|---------------------------------------|
| 1. Rear Glass Run Channel | 5. Regulator Assembly                 |
| 2. Rear Window Glass      | 6. Front Glass Run Channel            |
| 3. Retainer and Pivot Pin | 7. Front Run Channel Retaining Screws |
| 4. Regulator Lift Arm     |                                       |

### REAR QUARTER WINDOW ASSEMBLY—"A-37-67 and 87" Styles

#### Description

The rear quarter window assembly and related hardware components are similar on both the hardtop and convertible styles. There is a difference at the window guide upper attaching support bracket and the placement of the front up-stop. The upper attaching support on convertible styles is riveted to the guide and adjustments are available through slots at the return flange of the inner panel. The hardtop style support is bolted to the guide and adjustments are available at the bolt locations and also at the access hole slots in the inner panel. The front up-stop on convertible styles is secured to the window guide and is not adjustable. The hardtop style front up-stop is attached to the quarter inner panel and is adjustable. The other two stops (down and rear-up) are common on all styles. Figure 7-13 shows the rear quarter window assembly and Figure 7-14 shows the component parts of the rear quarter window assembly.

#### Removal and Installation

1. Remove rear seat cushion, seat back, rear quarter trim and inner panel water deflector and/or loading hole cover. On "67" Styles, lower folding top.

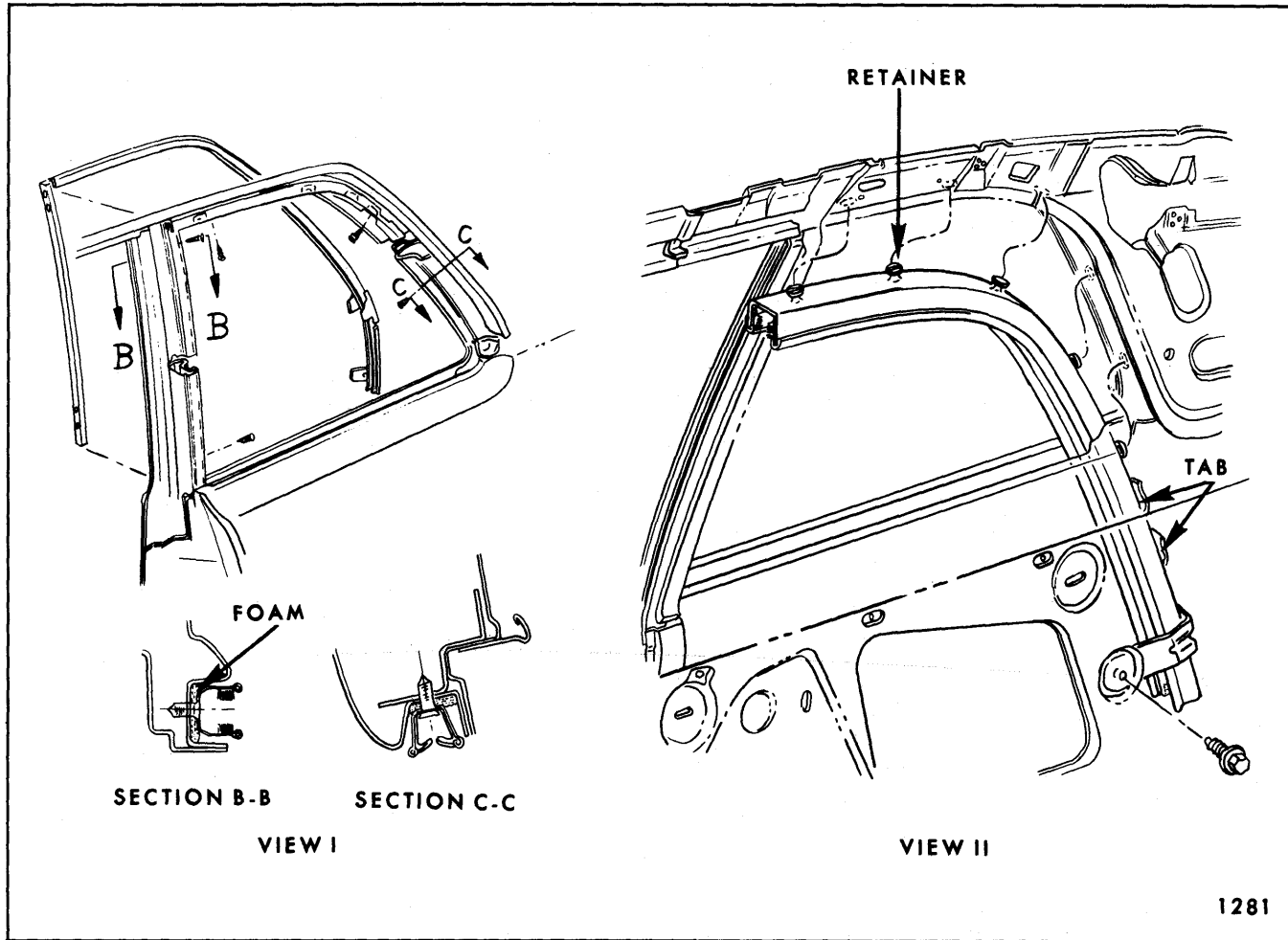

Fig. 7-8—Rear Quarter Window Glass Run Channels - Typical of all Closed Styles

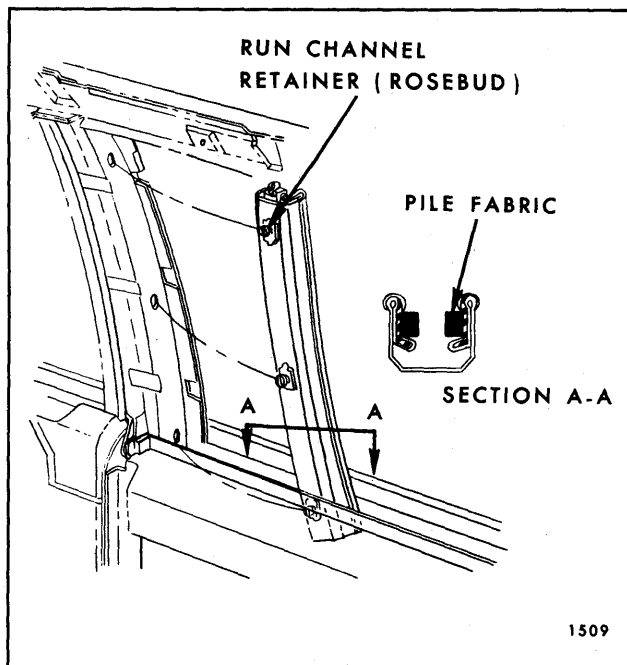

Fig. 7-9—Rear Quarter Window Front Glass Run Channels

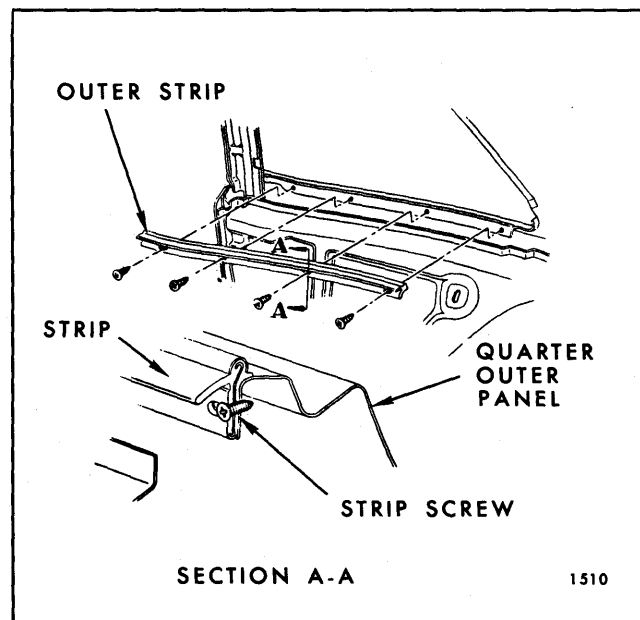

Fig. 7-10—Rear Quarter Window Outer Strip Assembly  
Closed Styles

2. On "67" Styles, remove window guide upper support to inner panel attaching bolts. On "37" and "87" Styles, remove upper support to window guide attaching bolts (Fig. 7-15).
3. Remove rear up-travel stop.
4. Loosen window guide lower attaching bolt and tilt glass to enable disengagement of lift arm roller from sash channel cam.
5. Lift glass straight up for disengagement from guide. On "67" Styles, clear front up-travel stop away from guide to allow clearance for glass lower roller. Remove glass outboard of side roof rail.
6. To install reverse removal procedure. It may be necessary to remove the window guide lower attaching bolts to permit greater movement of the guide when loading window assembly.

## REAR QUARTER WINDOW— "A-37-67 and 87" Styles

### Adjustments

The rear quarter window guide is secured to the quarter inner panel at the bottom and top with support brackets. These support brackets provide both in and out and fore or aft adjustment of the glass (Items 7 and 11 in Fig. 7-16). One down-stop and two up-stops are provided for alignment operations. The rear up-stop and lower down-stop are common on all styles; however, the front up-stop on convertible styles is attached to the guide and is not adjustable. The front up-stop on hardtop styles is attached to the quarter inner panel, and is adjustable.

**NOTE:** Rear quarter glass employs three nylon rollers attached to the glass. To remove any of these nylon rollers, use special tool J-22055 or its equivalent (Figure 7-17). When reinstalling nylon rollers, torque to 72 inch pounds (6 foot pounds).

## REAR QUARTER WINDOW "F-37 AND 67" STYLES

### Removal and Installation

1. Remove rear quarter trim assembly and inner panel water deflector or loading hole covers.
2. On convertible styles, lower folding top.
3. Remove glass inner and outer strip assembly.

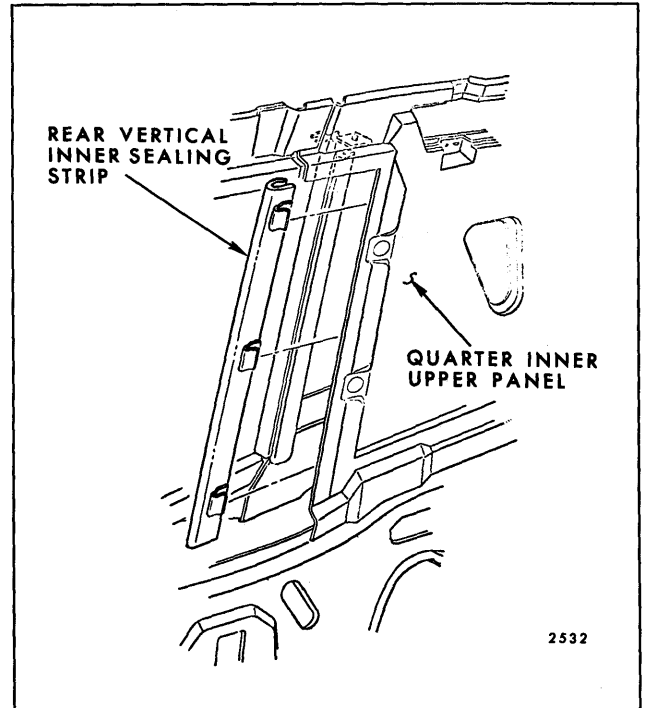

Fig. 7-11—Rear Quarter Window Rear Vertical Inner Sealing Strip Assembly "C-47" Styles

4. Remove window guide upper and lower attaching nuts (Fig. 7-18).
5. Support glass with one hand and position to enable disengagement of lift arm roller from sash channel cam.
6. Remove glass straight up and outboard of side roof rail on hardtop styles.
7. To install, reverse removal procedure.

## REAR QUARTER WINDOW "F-37 AND 67" STYLES

### Adjustments

In or out fore or aft adjustment is provided by inner panel slots and adjusting studs of the window guide. Up-travel of the glass is controlled by a stop located on the regulator assembly (Fig. 7-18).

**NOTE:** Figure 7-19 illustrates relationship of window assembly to guide. Figure 7-20 illustrates component parts of the rear quarter window assembly. Figure 7-21 illustrates the quarter window hardware in the installed position.

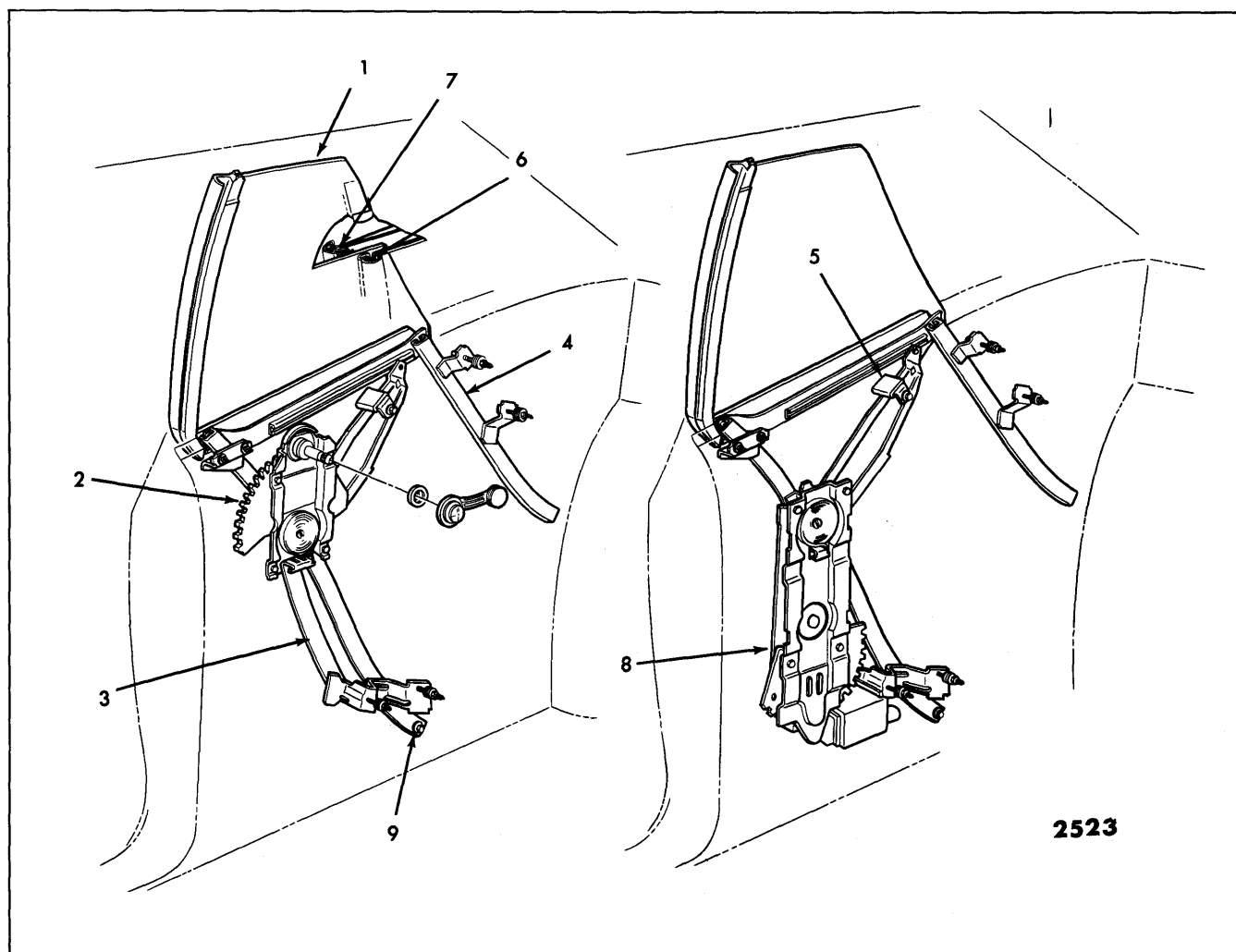

Fig. 7-12—Rear Quarter Hardware - "C-47" Styles Shown, "B-C 57-67" Styles Similar

- |                            |                             |                         |                      |
|----------------------------|-----------------------------|-------------------------|----------------------|
| 1. Quarter Window Assembly | 4. Rear Guide               | 7. Section Through Roof | 8. Window Regulator  |
| 2. Window Regulator        | 5. Window Upper Stop        | Rear Drip Molding       | (Electric)           |
| (Manual)                   | 6. Section Through Vertical | (With Integral Outer    | 9. Window Lower Stop |
| 3. Front Guide             | Inner Sealing Strip         | Sealing Strip)          |                      |

## REAR QUARTER WINDOW "E-87" STYLES

### Removal and Installation

1. With window in a full-up position, remove rear guide upper and lower attaching bolts. Disengage guide from roller on window assembly and remove guide through access hole (see Fig. 7-22).
2. With quarter window partially lowered, remove nuts securing regulator lift arm cam to regulator lift arm and remove cam.
3. While supporting glass, remove quarter window front guide attaching bolts and lower guide to bottom of rear quarter.
4. Remove quarter window inboard of roof panel.
5. To install, reverse removal procedure. Fig. 7-23 is an exploded view of the quarter window assembly and identifies the various components and their assembly sequence.

**NOTE:** Lift arm must be pushed inboard slightly to remove cam.

### Adjustments

Fore and aft alignment is determined by positioning front guide. Adjusting rear guide will provide parallel condition of quarter window to door for



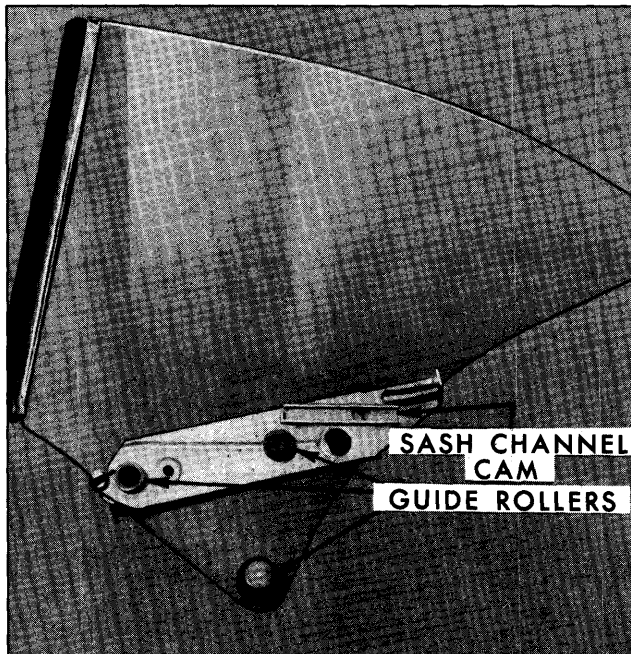

Fig. 7-13—Rear Quarter Window Assembly "A - 37, 67 & 87" Styles

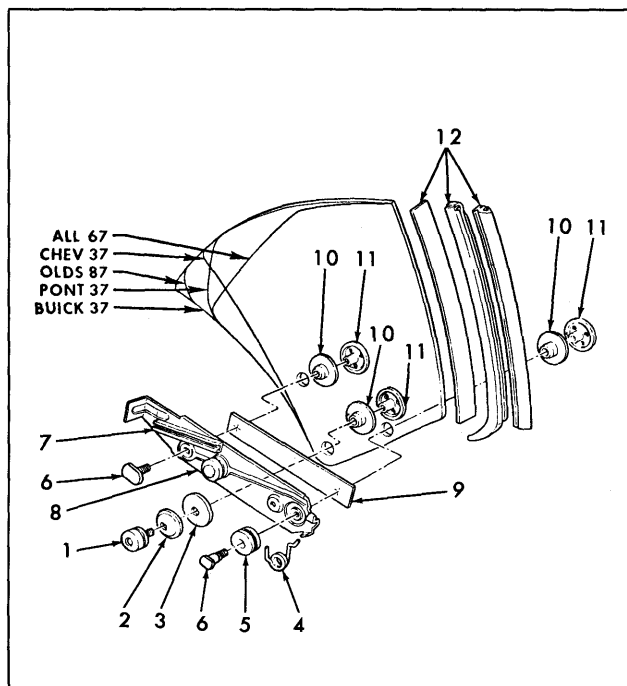

Fig. 7-14—Rear Quarter Window Assembly "A - 37, 67, 87" Body Styles

- |                               |                                 |
|-------------------------------|---------------------------------|
| 1. Guide Lower Roller         | 7. Lower Sash Channel Cam       |
| 2. Guide Roller Washer-Rubber | 8. Lower Sash Channel           |
| 3. Guide Roller Washer        | 9. Lower Sash Channel Filler    |
| 4. Guide Roller Spring        | 10. Glass to Sash Bushing       |
| 5. Guide Front Roller         | 11. Glass to Sash Nut           |
| 6. Glass to Sash Bolt         | 12. Front Vertical Weatherstrip |

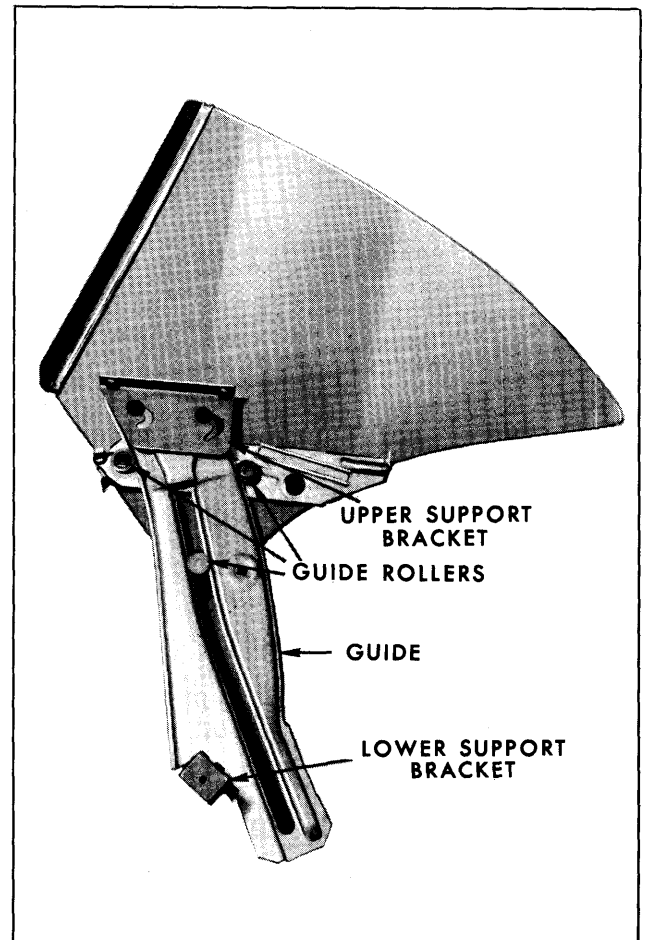

Fig. 7-15—Rear Quarter Window and Guide Assembly "A - 37, 67, 87" - Styles

constant seal. In or out alignment is determined by upper two adjusting studs and nuts at front guide. The adjustable up-stop will provide up or down alignment and partially fore and aft alignments by controlling window travel. Figures 7-24 (Buick) and 7-25 (Oldsmobile) illustrate the rear quarter window hardware components.

**NOTE:** Adjustments on regulator lift arm cam are provided to permit maximum travel but caution must be observed so not to interfere with quarter trim assembly at belt.

## REAR QUARTER WINDOW CADILLAC "E-47" STYLES

### Removal and Installation

1. Remove necessary trim, inner panel water deflector, body lock pillar pressure relief valve grille and body lock pillar upper sealing strip.

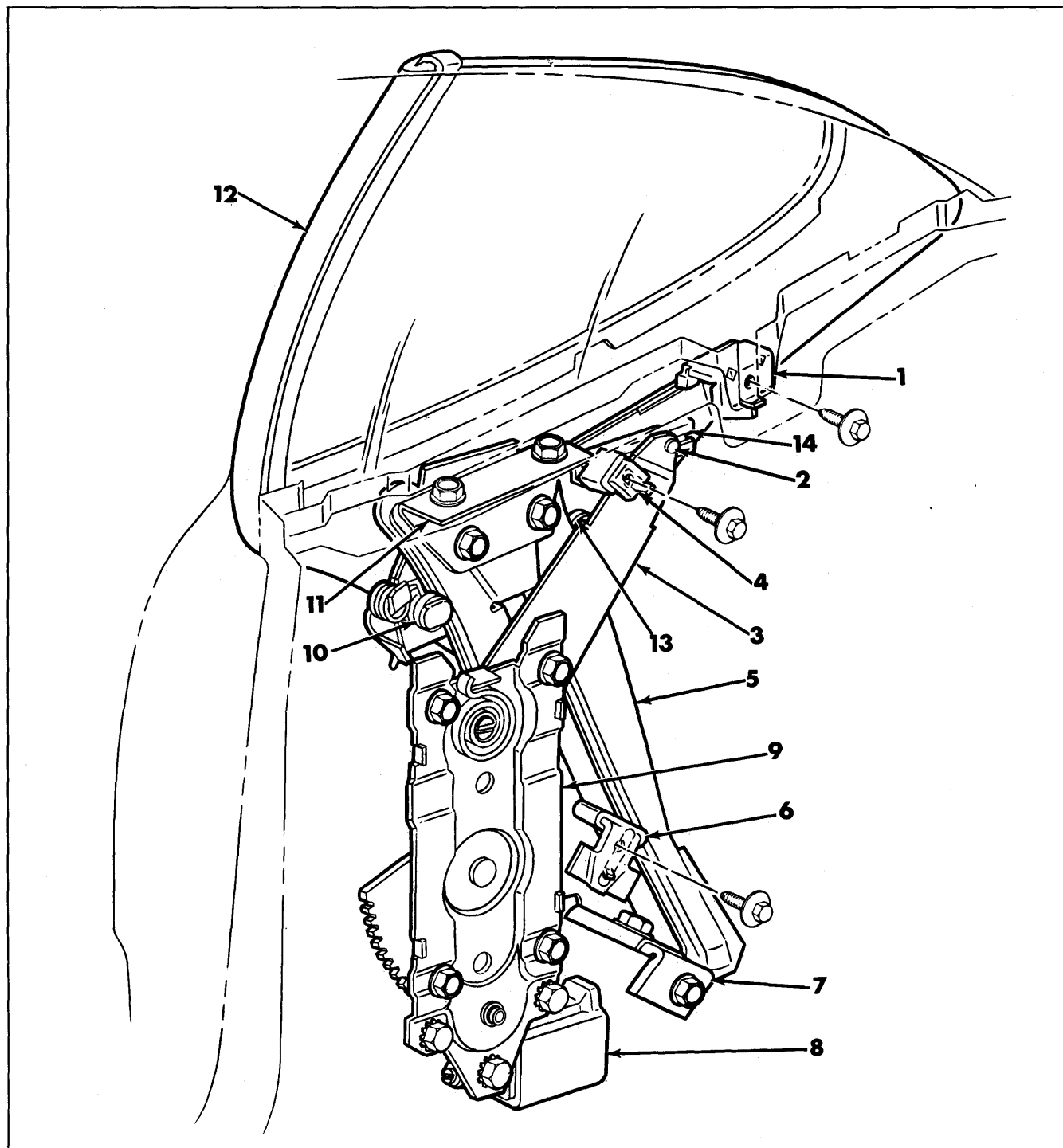

Fig. 7-16—Rear Quarter Hardware "A - 37, 67, 87" Styles

- |                              |                                |                         |                             |
|------------------------------|--------------------------------|-------------------------|-----------------------------|
| 1. Rear Up-Stop              | 5. Window Guide                | 9. Regulator Assembly   | 12. Front Vertical Weather- |
| 2. Regulator Lift Arm Roller | 6. Down-Stop                   | 10. Front Roller        | strip                       |
| 3. Regulator Lift Arm        | 7. Lower Guide Support Bracket | 11. Upper Guide Support | 13. Rear Roller             |
| 4. Front Up-Stop             | 8. Electric Motor              | Bracket                 | 14. Sash Channel Cam        |



Fig. 7-17—Tool J-22055 - Quarter Window Roller

2. Lower quarter window to gain access to nut securing regulator lift arm and stop to lower sash channel roller and remove nut (Item 4 in Figure 7-26). Disconnect lift arm from sash channel cam.

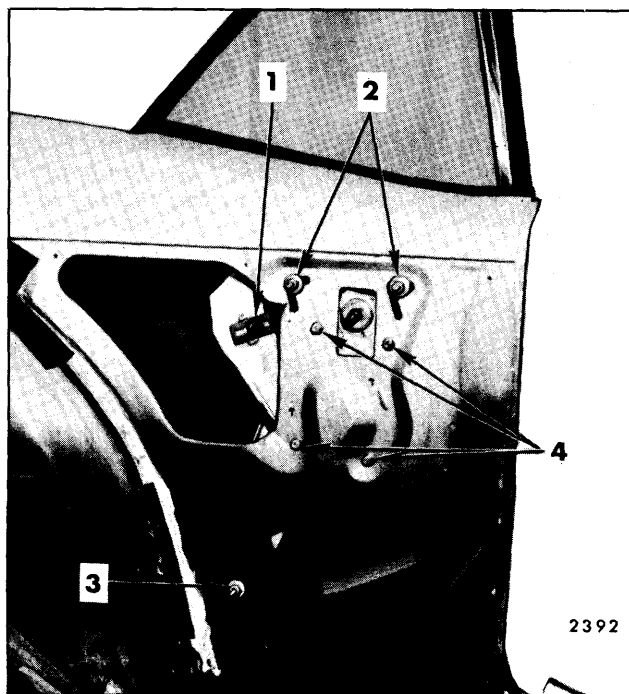

Fig. 7-18—Rear Quarter Window Hardware - "F" Styles

- |   |                              |
|---|------------------------------|
| 1. Window Up-Stop                             | 3. Window Guide              |
| 2. Window Guide Upper Adjusting Stud and Nuts | Lower Adjusting Stud and Nut |
|   | 4. Window Regulator Bolts    |

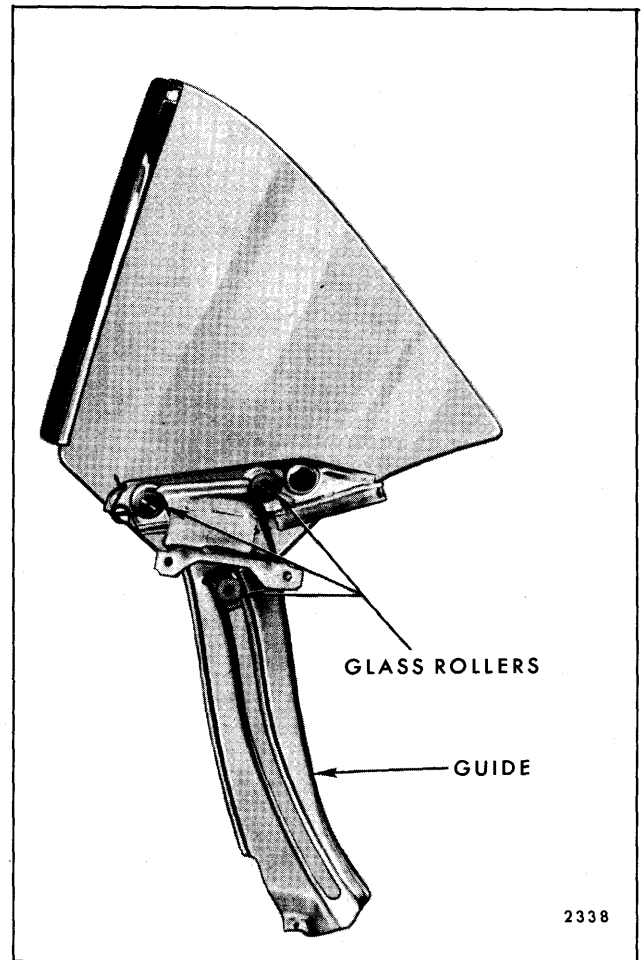

Fig. 7-19—Rear Quarter Window and Guide Assembly - "F" Styles

3. Remove two nuts securing inner panel cam to inner panel (Item 1 in Figure 7-26).
4. Remove adjusting studs from inner panel cam.
5. Remove inner panel cam through lock pillar pressure relief valve opening.
6. Pull quarter glass forward. Remove glass in-board of side roof rail. Figure 7-27 shows quarter glass after removal.
7. To install, reverse removal procedure.

### Adjustments

Critical rear quarter window adjustments can be achieved at the lock pillar and **DO NOT** require seat and side wall trim removal (see Fig. 7-28).

1. Remove lock pillar grille.

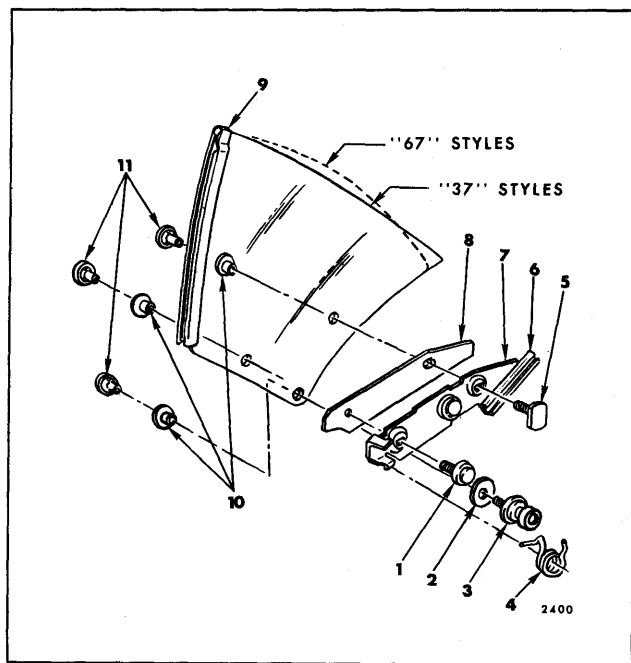

Fig. 7-20—Rear Quarter Window Assembly - "F" Styles

- |                                 |                                   |
|---------------------------------|-----------------------------------|
| 1. Lower Sash Channel           | 7. Lower Sash Channel             |
| 2. Guide Roller Washer (Rubber) | 8. Lower Sash Channel Filler      |
| 3. Guide Lower Roller           | 9. Vertical Sash Channel          |
| 4. Guide Roller Spring          | 10. Glass to Sash Channel Bushing |
| 5. Glass to Sash Channel Bolt   | 11. Glass to Sash Channel Nut     |
| 6. Lower Sash Channel Cam       |                                   |

- The forward glass stop can be adjusted fore and aft by loosening lock nut and turning stud in or out (see Fig. 7-28).

**NOTE:** Stop bolt also retains forward attachment of glass run channel.

- A slight amount of in or out adjustment of glass is provided by an elongated slot at glass run channel forward attachment (see Figure 7-28).

- A secondary glass stop is located in the vertical sash channel cam (see Fig. 7-29). This stop is retained by a single bolt and is accessible through lock pillar opening (see Fig. 7-28).

**NOTE:** Major glass adjustment is available at inner panel cam adjusting studs and nuts (see Fig. 7-26). In addition, the glass run channel rear attachment provides in or out and up or down adjustment. Also, a glass lower stop is attached to the rear plate of the glass run channel. This stop is adjustable fore and aft.

## REAR QUARTER WINDOW "Z-37 AND 67" STYLES

### Removal and Installation

- With window in full-up position, remove rear guide upper and lower attaching bolts (Fig. 7-30 and 7-31). Disengage guide from roller on window assembly and remove guide.
- Remove regulator as described in a following procedure (see index).
- Slide rear quarter window upward and forward and pivot top rear corner of glass to a point outboard of side roof rail. Continue movement of glass upward and forward to disengage front glass rollers from front guide assembly and remove rear quarter window from body.
- To install, reverse removal procedure. Figure 7-32 is an exploded view of the quarter window assembly and identifies the various components and their assembly sequence.

### Adjustments

- The quarter window up-stop can be utilized for adjustments of glass to side roof rail weatherstrip (see Section "A-A" in Fig. 7-33).
- The rear guide can be adjusted to gain proper fore and aft contact of rear quarter window vertical weatherstrip to rear edge of front door window (see section "C-C" and "F-F" in Fig. 7-33).

## REAR QUARTER WINDOW "B & C 47-57-67 AND 87" STYLES

### Description

The rear quarter window assembly consists of a solid tempered safety plate glass window, a pressed-on front vertical sash channel and a bolt-on lower sash channel and cam assembly.

To service any of the component parts Figure 7-34 requires moving the entire window assembly from the body. Inaccessibility of the lower sash channel to glass attaching bolts prevents separation of glass from sash channel with window assembly installed.

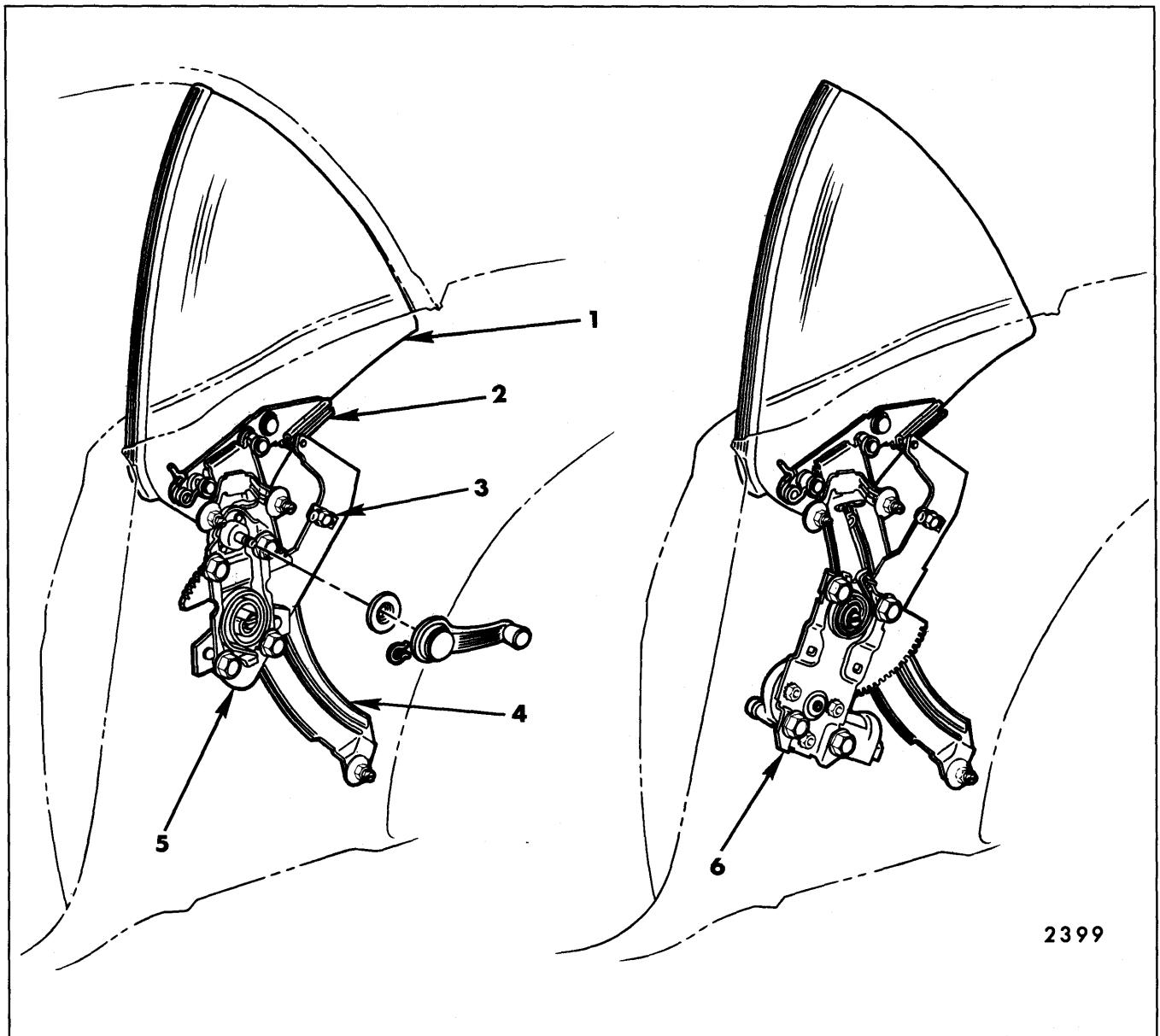

Fig. 7-21—Rear Quarter Hardware - "F" Body Styles

1. Rear Quarter Window  
2. Sash Channel Cam

3. Up-Stop  
4. Window Guide

5. Regulator (Manual)  
6. Regulator (Electric)

Figures 7-35 and 7-36, which are exploded views of the "47" and "87" style quarter windows, are typical of all hardtop and convertible styles.

**NOTE:** When reinstalling lower sash channel and nylon rollers to quarter window, torque attaching nuts to 72 inch pounds (6 foot pounds). Also, replace sash channel and nylon roller rubber spacers.

### Removal and Installation

1. Remove rear quarter trim assembly and inner panel water deflector or inner panel access hole cover. On "67" styles, lower folding top.
2. On "C-47" styles, remove roof rear drip molding (see "Molding" section) and quarter window rear vertical inner sealing strip assembly as described in a preceding procedure.

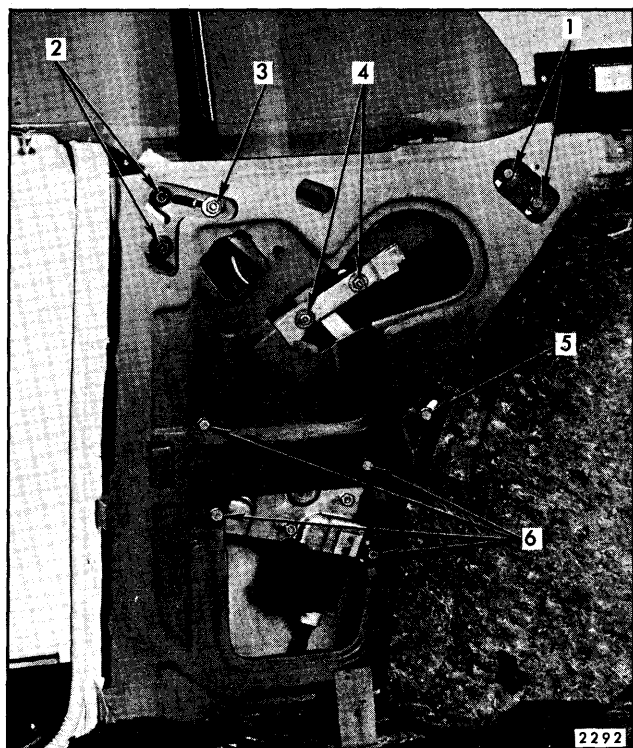

Fig. 7-22—Rear Quarter Hardware - "E" Body

- |   |   |
|---|---|
| 1. Rear Guide Attaching Bolts                 | 4. Regulator Lift Arm Cam Attaching Nuts                    |
| 2. Front Guide Upper Adjusting Studs and Nuts | 5. Front Guide Lower Attaching Bolt                         |
| 3. Up-Stop Attaching Bolts                    | 6. Regulator Attaching Bolts (4 for Electric, 5 for Manual) |

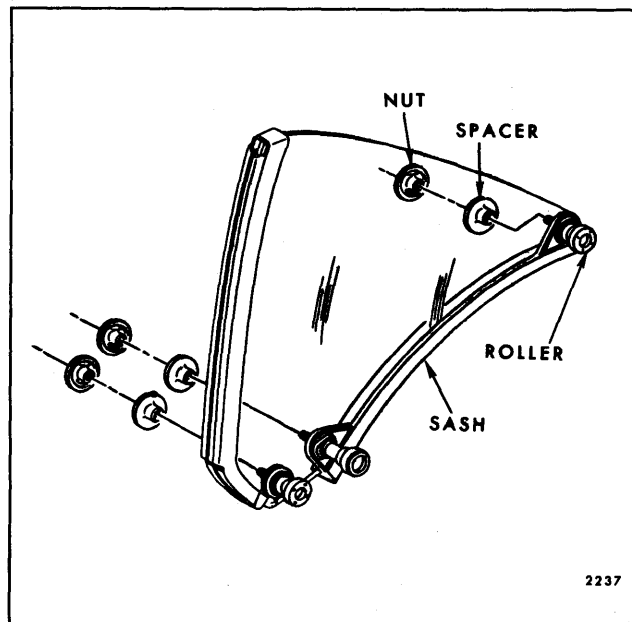

Fig. 7-23—Rear Quarter Window Assembly - "E-87" Styles

3. With window in full-up position, remove rear guide adjusting stud nuts ("1", Fig. 7-37). Disengage guide from roller on window assembly and remove guide through access hole.
4. With window lowered to half-down position, remove front guide lower adjusting stud nuts "2", and loosen upper adjusting stud nuts "3", push lower adjusting studs "2" outboard to disengage from slots in inner panel.
5. Grasping both window assembly and lower end of front guide, swing them forward sufficiently to disengage window regulator lift arm roller from lower sash channel cam at rear of cam.
6. Supporting window assembly, allow front guide upper adjusting studs "3" to drop to bottom of the slots provided in inner panel.
7. Remove window assembly by lifting upward and inboard.
8. To install, reverse removal procedure. Adjust window for proper alignment as described in following adjustment procedure.

### Adjustments

1. Rear quarter window up-travel is determined by position of the window up stop "4" (Fig. 7-37). To change the window upper limits, loosen the stop attaching bolt and position the stop as desired.
2. Fore or aft position of the window is determined by the position of the front and rear guides. To adjust the window, loosen the front, and rear guide adjusting stud nuts "1", "2" and "3" (Fig. 7-37) and reposition the window as required.
3. In or out adjustment of the window assembly, or only the top of the window, can be obtained by utilizing the front and rear guide adjusting studs (Fig. 7-37). To reposition the window in or out, adjust the guide upper and lower adjusting studs in the same direction. To adjust the top of the window in or out, adjust the lower adjusting studs in the opposite direction of the upper studs.
4. To control the down-travel of the quarter window (fully lowered position), adjust the down-travel stop. The down stop is located in the

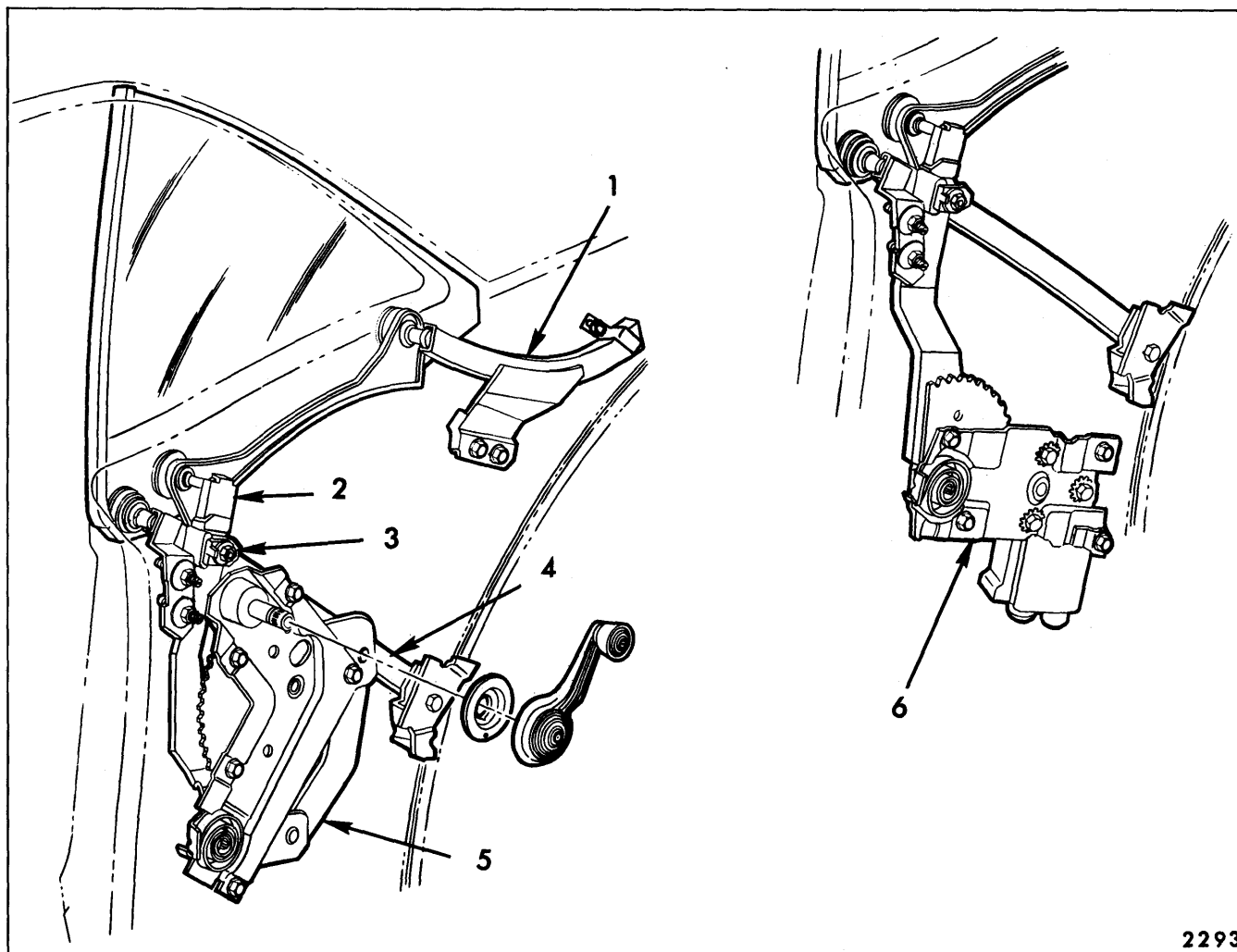

Fig. 7-24—Rear Quarter Hardware - Buick "E" Styles

1. Rear Guide  
2. Regulator Lift Arm Cam

3. Up-Stop  
4. Front Guide

5. Regulator (Manual)  
6. Regulator (Electric)

sash channel cam on "B-C 67" and "C-57" styles ("5", Fig. 7-37), and in the front guide on the remaining "B-C" hardtop styles as shown in Figure 7-38.

## REAR QUARTER WINDOW REGULATOR (MANUAL OR ELECTRIC)— "B-C 47-57-67-87" Styles

### Removal and Installation

1. Remove rear quarter trim assembly. On "67" styles remove inner panel access hole cover. On "47-57-87" styles, remove inner panel water deflector.

2. On "67" styles with electric window regulators, disconnect wire harness at in-line connector located inboard of inner panel. DO NOT attempt to disconnect permanent connector at motor. On "47-57-87" styles, disconnect wire harness connector at motor.
3. If window regulator failed with window in full-up position, proceed as follows:
  - a. Prop window in full-up position.
  - b. Remove window regulator attaching bolts "6", (Fig. 7-37).
  - c. Disengage regulator lift arm roller from lower sash channel cam at rear of cam and remove regulator through access hole.

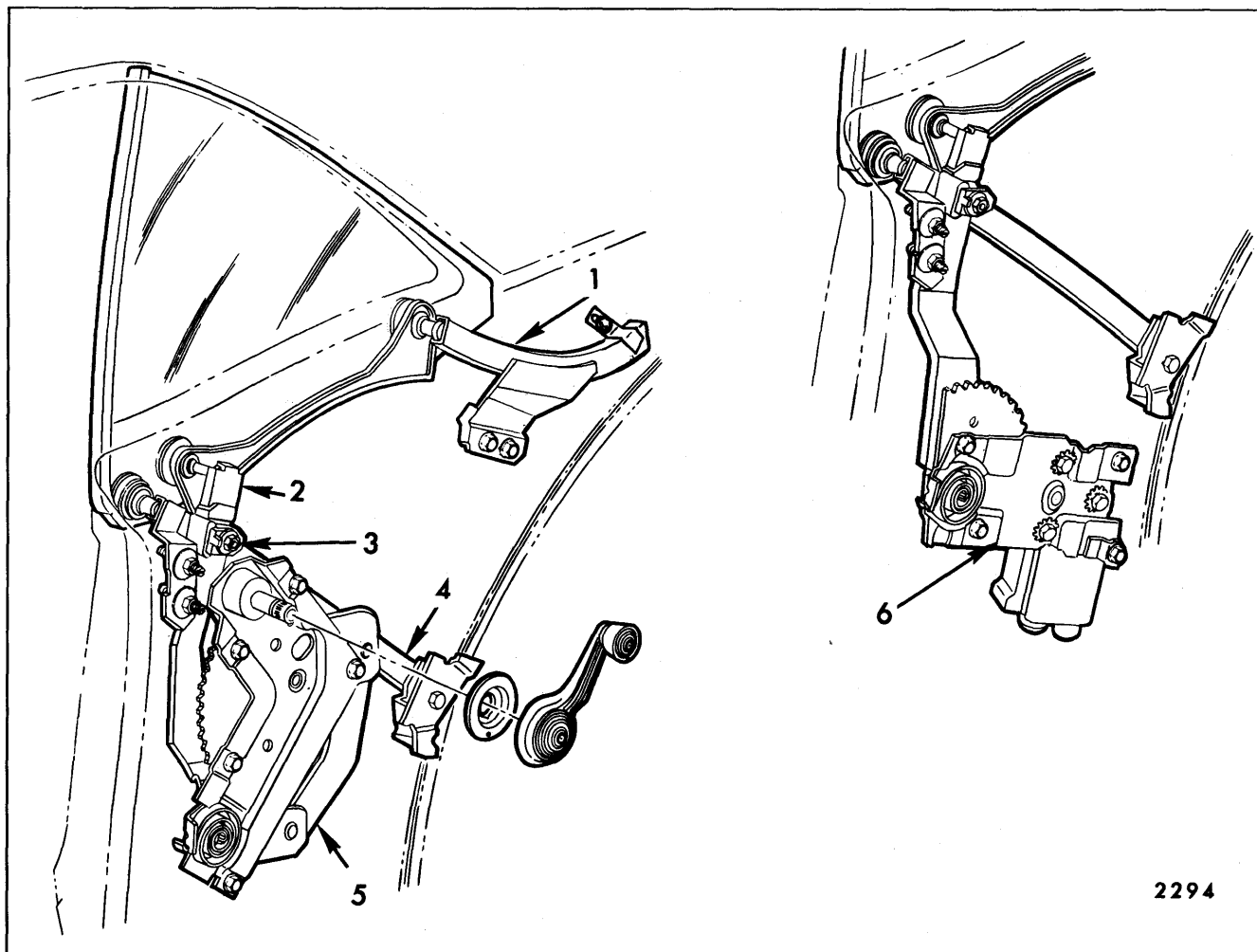

Fig. 7-25—Rear Quarter Hardware - Oldsmobile "E" Body

- |                           |                |                         |
|---------------------------|----------------|-------------------------|
| 1. Rear Guide             | 3. Up-Stop     | 5. Regulator (Manual)   |
| 2. Regulator Lift Arm Cam | 4. Front Guide | 6. Regulator (Electric) |

4. If regulator failed with window in full-down position, proceed as follows:

- a. Remove regulator attaching bolts "6" (Fig. 7-37).
- b. Supporting window, move regulator forward to disengage lift arm roller at front of lower sash channel cam.

**NOTE:** On styles with down stop in cam ("5", Fig. 7-37), remove stop prior to disengaging regulator roller.

- c. Manually raise window and prop in full-up position.

d. Remove regulator through access hole.

5. To install, reverse removal procedure.

### REAR QUARTER WINDOW REGULATOR ASSEMBLY (Manual or Electric)— "A-E-F & Z" Hardtop and Convertible Styles

#### Removal and Installation

1. Remove rear quarter trim assembly and inner panel access hole cover (or water deflector).



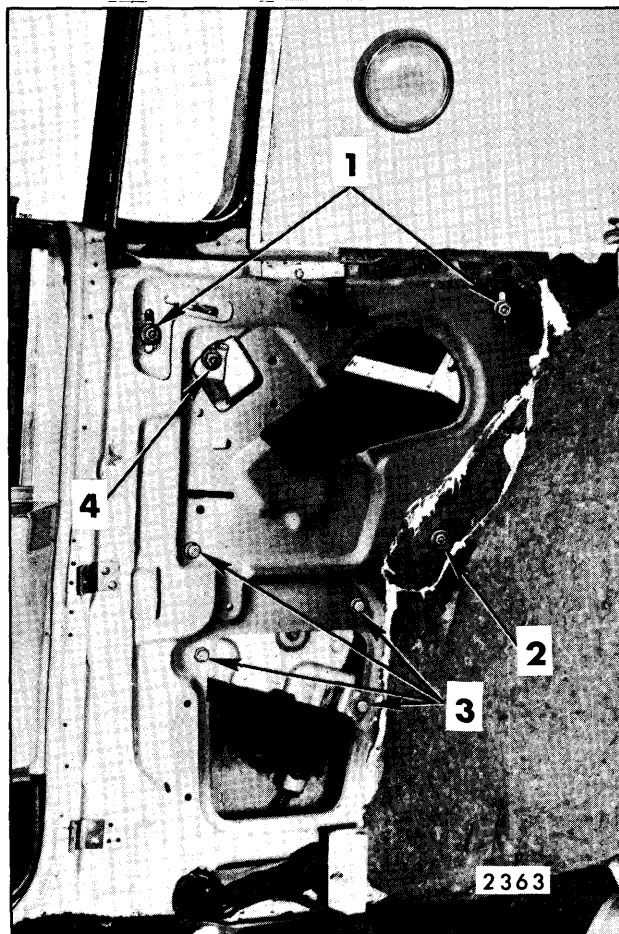

Fig. 7-26—Rear Quarter Hardware - "E-47" Styles

- |  |   |
|--|---|
| 1. Inner Panel Cam Adjusting Studs and Nuts      | 3. Regulator Attaching Bolts                            |
| 2. Glass Run Channel Rear Adjusting Stud and Nut | 4. Regulator Lift Arm to Cam Glass Roller Attaching Nut |

On electric styles, disconnect feed wire from regulator or "in-line" connector.

- On "E-87" styles, remove rear quarter window. on "A & Z-37" styles, prop window in a full-up position
- On "Z-37" styles, remove rear quarter window rear guide assembly.
- On "E-47" styles, disconnect regulator lift arm from quarter window as described in "Rear Quarter Window Assembly" (see index).
- Remove regulator to quarter inner panel attaching bolts, disengage lift arm roller from sash channel cam and remove regulator.

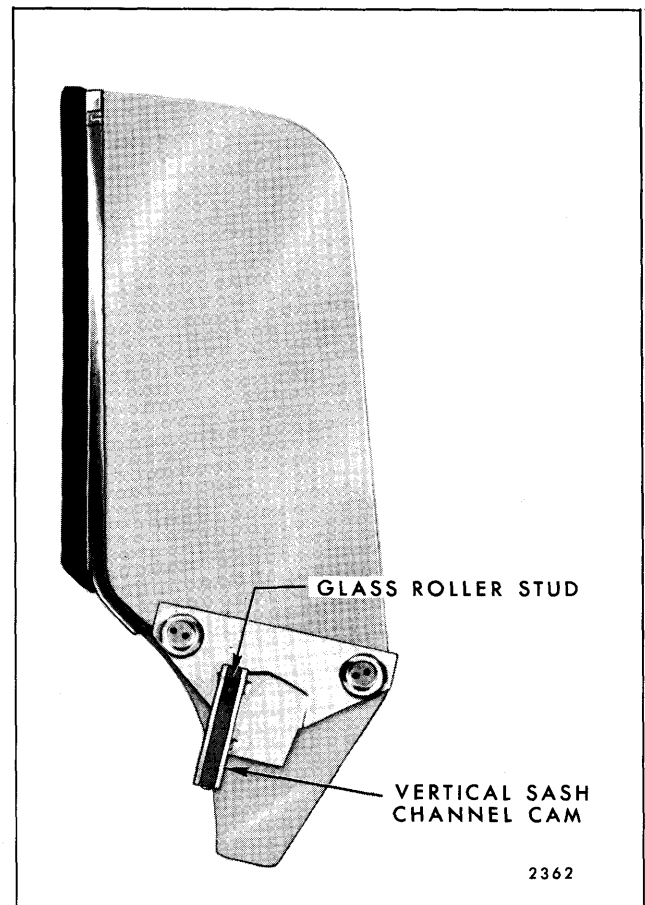

Fig. 7-27—Rear Quarter Window Assembly - "E-47" Styles

**NOTE:** If necessary, loosen upper attaching points of front guide to gain additional clearance.

- To install, reverse removal procedure.

**NOTE:** The procedure for removing the electric motor from the regulator is described under "Door and/or Quarter Window Regulator Electric Motor Assembly".

## REAR QUARTER WINDOW REGULATOR (MANUAL AND ELECTRIC)— "A, B & X" Closed Styles

### Removal and Installation

- Remove rear quarter trim assembly and inner panel water deflector. On electric styles, disconnect feed wire from regulator motor.

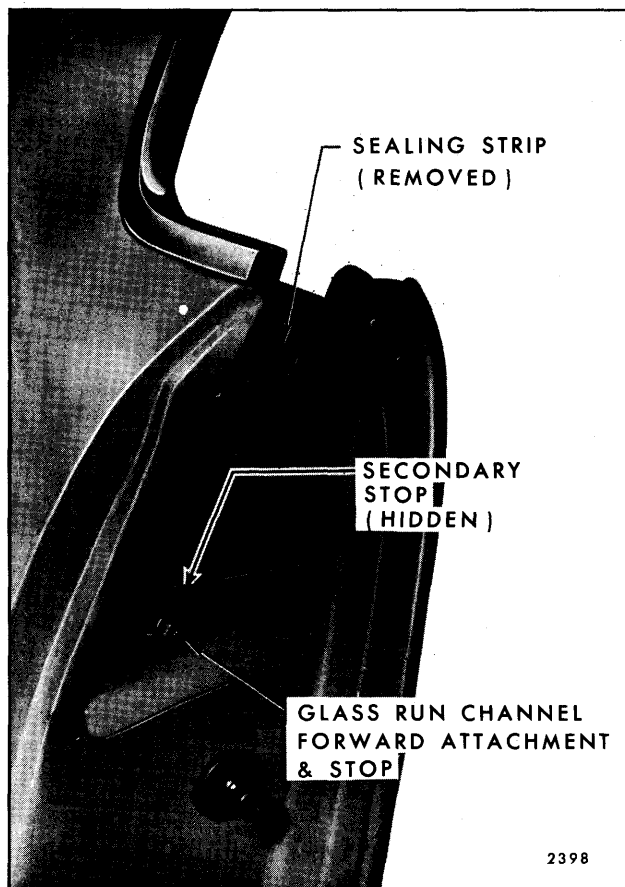

Fig. 7-28—Rear Quarter Window Hardware Attachments on Lock Pillar

2. On "A & B" styles, disengage clip retainer from pivot pin on window lower sash channel (see Fig. 7-3 and 7-4). Raise window to full-up and prop in that position.
3. On "X" styles, remove support to regulator plate screws. Raise window to full-up and prop in that position.
4. On "A & B" styles, remove regulator to inner panel screws and remove regulator through large access hole (see Fig. 7-39).
5. On "X" styles, remove regulator to inner panel screws. Disengage roller on regulator plate from window guide and remove regulator through large access hole.
6. To install, reverse removal procedure.

**NOTE:** The procedure for removing electric motor from regulator is described under "Door and Quarter Window Regulator Electric Motor Assembly" in the Door section of this manual.

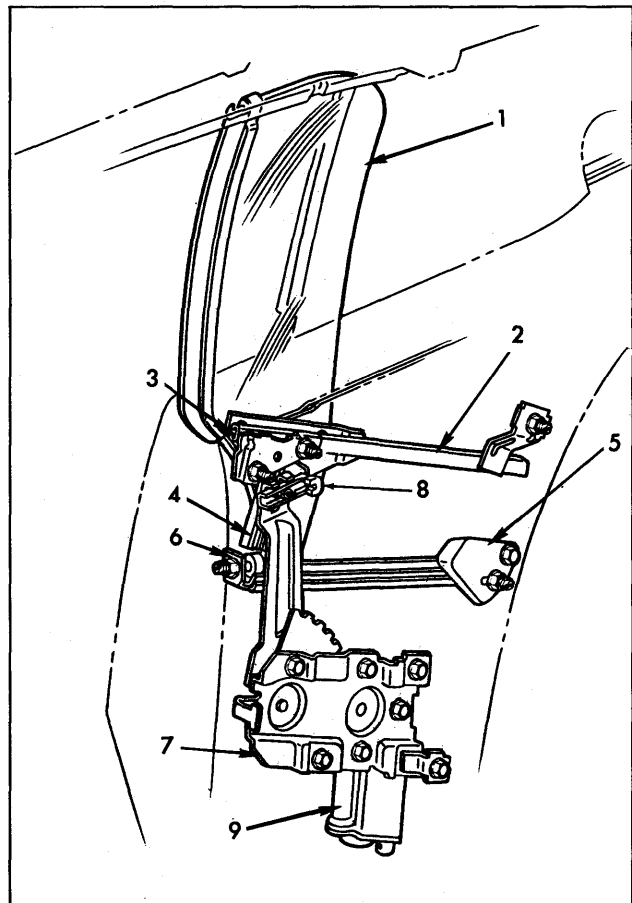

Fig. 7-29—Rear Quarter Hardware - Cadillac "E" Body

- |                      |                       |
|----------------------|-----------------------|
| 1. Glass             | 4. Regulator Assembly |
| 2. Sash Channel Cam  | 5. Down-Stop          |
| 3. Glass Run Channel | 6. Front Stop         |
|                      | 7. Vertical Cam       |

## REAR QUARTER WINDOW FRONT GUIDE—"B-C 47-57-67-87" Styles

### Removal and Installation

1. Remove rear quarter trim assembly and inner panel water deflector or access hole cover.
2. With window in full-up position, remove front guide upper and lower adjusting stud nuts ("2" and "3", Fig. 7-37).
3. Pull guide downward and rearward to disengage from rollers on window assembly and remove guide through access hole.
4. To install, reverse removal procedure.

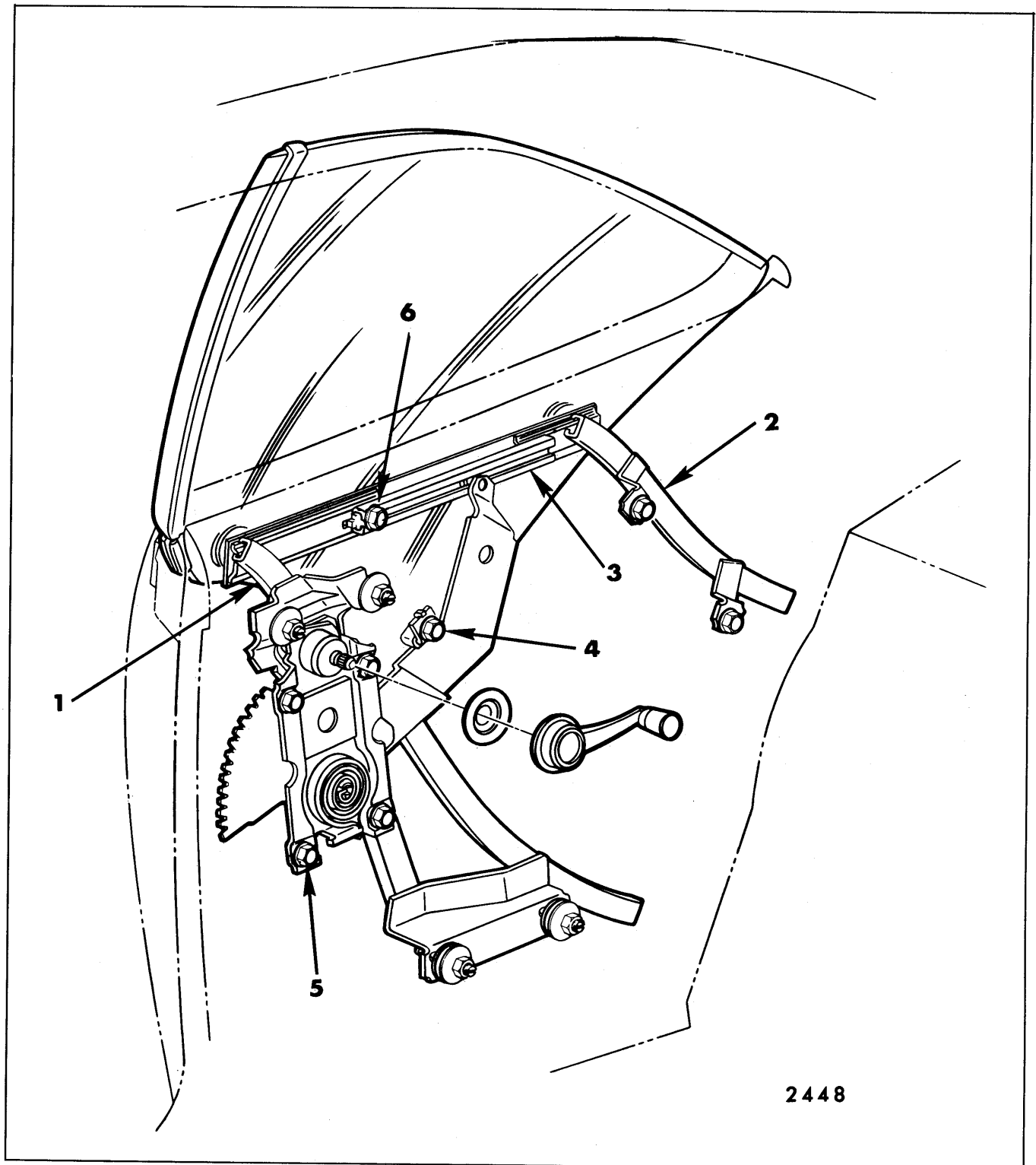

Fig. 7-30—Rear Quarter Hardware - "Z-37" Styles

1. Front Guide  
2. Rear Guide

3. Lower Sash Channel Cam  
4. Window Up-Stop

5. Window Regulator  
6. Window Down-Stop

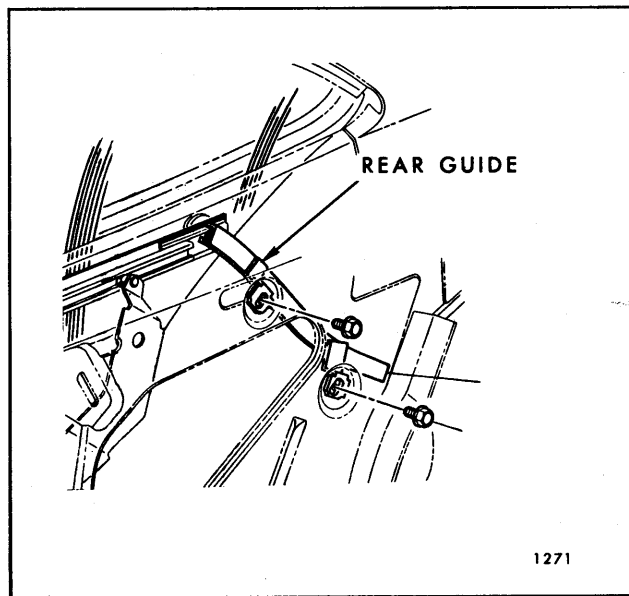

Fig. 7-31—Rear Quarter Window Rear Guide Assembly - "Z-37" Styles

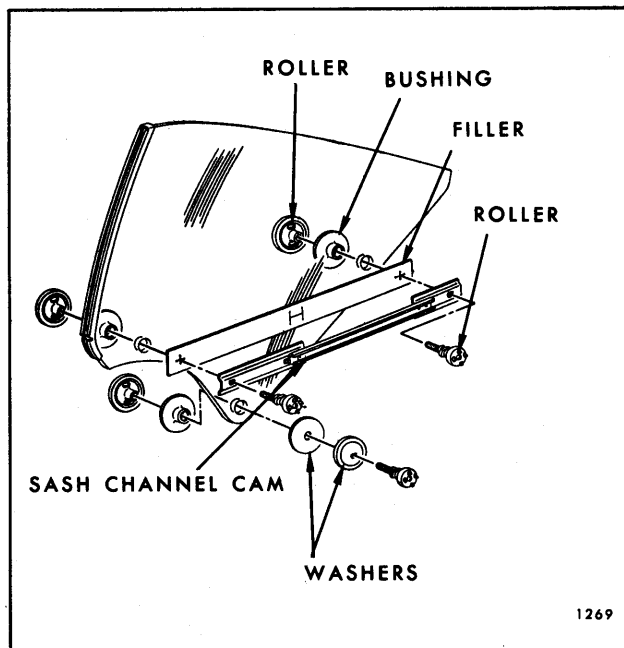

Fig. 7-32—Rear Quarter Window Assembly - "Z-37" Styles

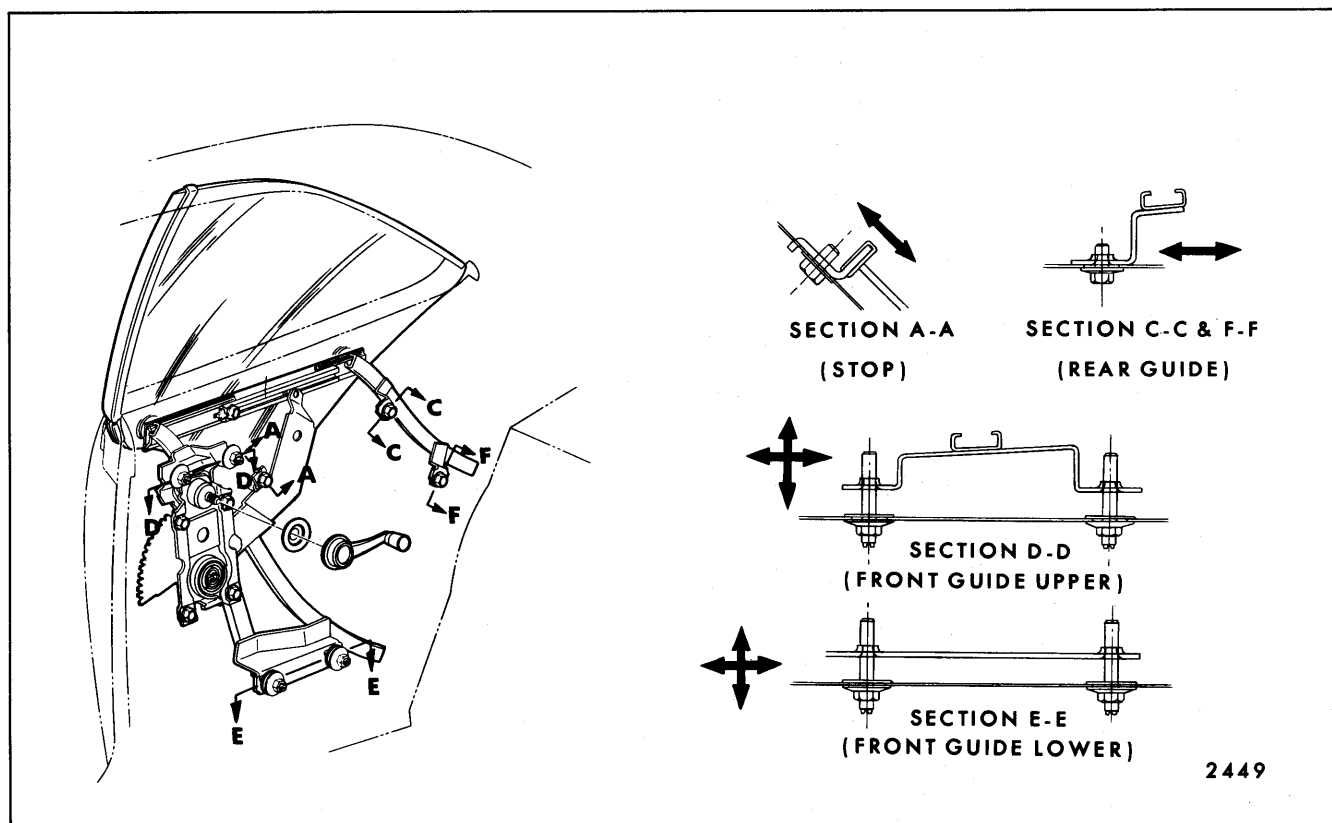
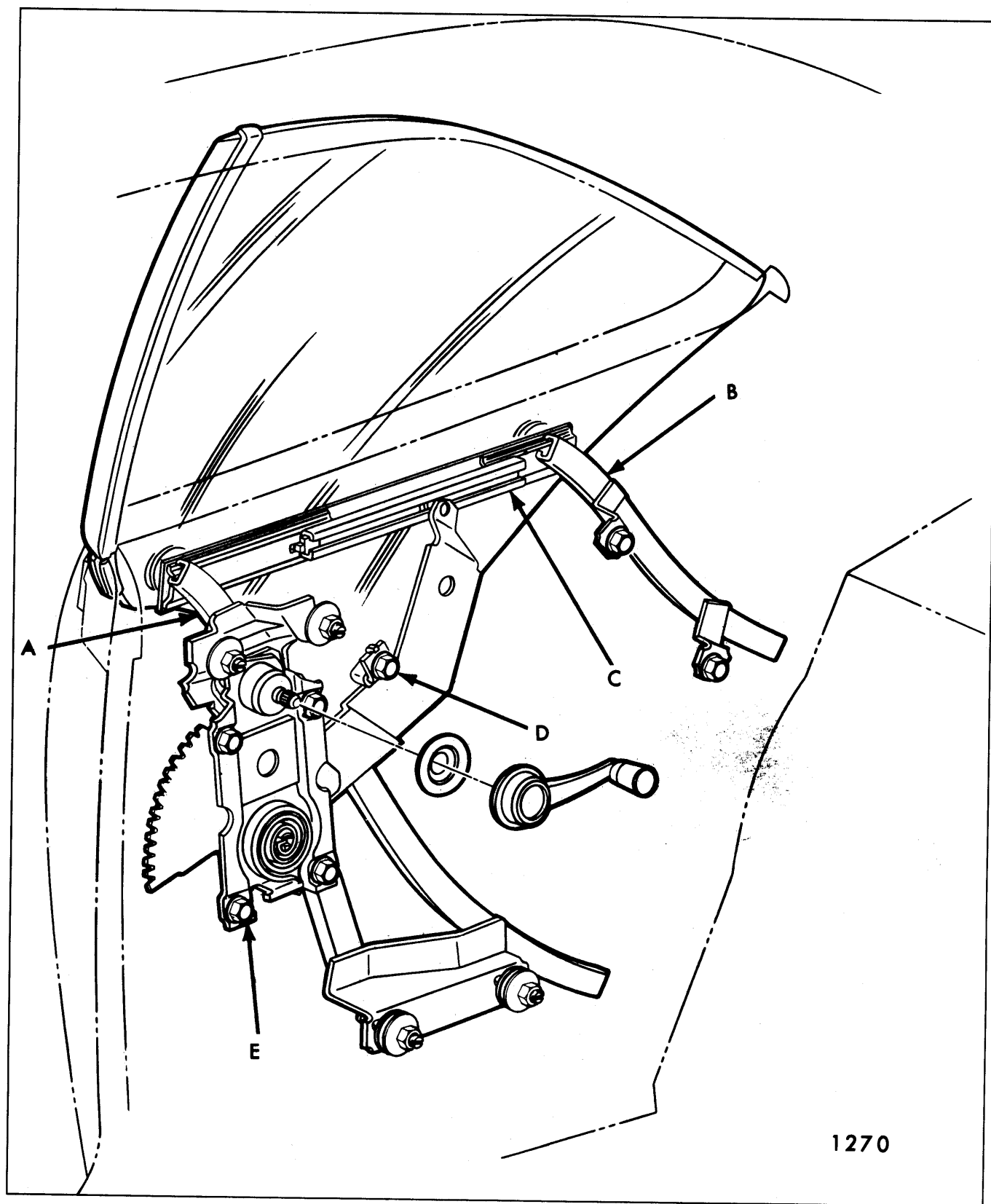

Fig. 7-33—Rear Quarter Window Adjustments - "Z-37" Styles (Arrows Indicate Adjustment Direction Available)



1270

Fig. 7-34—Rear Quarter Hardware - "B-87" Styles

A. Front Guide  
B. Rear Guide

C. Lower Sash Channel Cam  
D. Window Up-Stop

E. Window Regulator

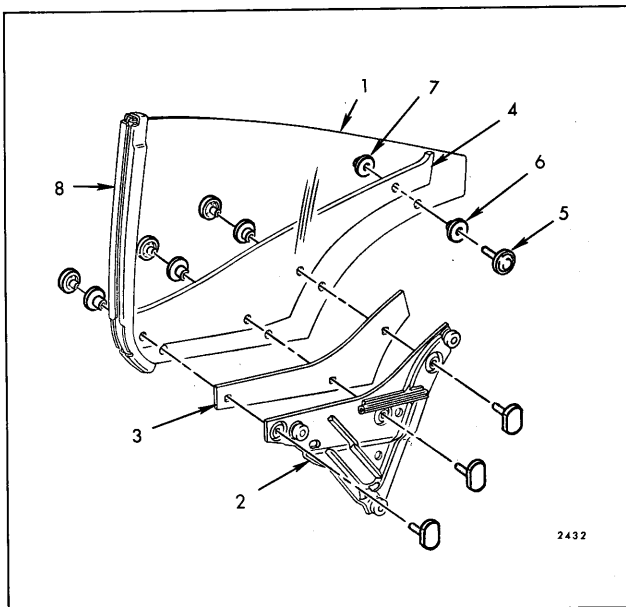

Fig 7-35—Rear Quarter Window Assembly - "B-87" Styles

- |                                    |                                    |
|------------------------------------|------------------------------------|
| 1. Rear Quarter Window             | 4. Lower Sash Channel Outer Filler |
| 2. Lower Sash Channel Assembly     | 5. Bolt                            |
| 3. Lower Sash Channel Inner Filler | 6. Spacer                          |
|                                    | 7. Nut                             |
|                                    | 8. Front Vertical Sash Channel     |

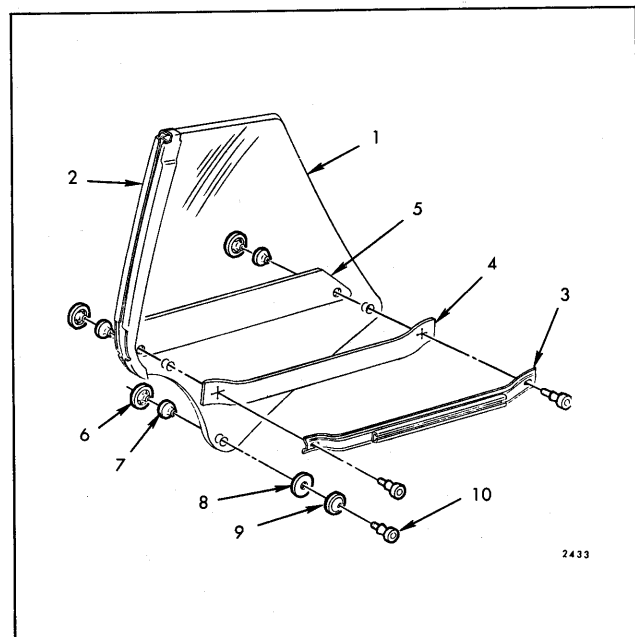

Fig. 7-36—Rear Quarter Window Assembly - "B-C-47-57-67" Styles

- |   |                    |
|---|--------------------|
| 1. Rear Quarter Window                                    | 6. Nut             |
| 2. Front Sash Channel                                     | 7. Spacer (Rubber) |
| 3. Lower Sash Channel                                     | 8. Washer (Rubber) |
| 4. Lower Sash Channel Inner Filler                        | 9. Washer (Metal)  |
| 5. Lower Sash Channel Outer Filler (Not on "B-57" Styles) | 10. Roller         |

## REAR QUARTER WINDOW FRONT GUIDE ASSEMBLY—"Z" Hardtop and Convertible and "E-87" Styles

### Removal and Installation

1. Remove rear quarter window assembly.
2. On "Z" styles, remove front guide upper and lower adjusting stud nuts (see Figs. 7-40 and 7-41, which are typical of "Z-37, 67" and "E-87" styles).

**NOTE:** As explained under "Rear Quarter Window Assembly" - Removal and Installation for "E" bodies, the front guide attachments must be removed and guide lowered prior to removal of window assembly.

3. Disengage guide adjusting studs from slots in quarter inner panel and remove guide through access hole on all except "E" styles. On "E" bodies, remove front guide between rear quarter inner and outer panels at belt.

4. To install, reverse removal procedure. Adjust guide for proper window operation as specified under "Rear Quarter Window Adjustments".

**NOTE:** The rear channel of the front guide of most styles is equipped with an adjustable lower stop to control height of quarter window in the lowered position (see Fig. 7-38).

## REAR QUARTER WINDOW REAR GUIDE ASSEMBLY—"Z" Hardtop and Convertible Styles and "E-87" Styles

### Removal and Installation

1. Remove rear quarter trim assembly and inner panel water deflector (or access hole cover).
2. As shown in Figures 7-31, 7-40, 7-41 and all phantom views, rear guides are retained by two bolts or adjusting studs. By providing a minimum of support for rear quarter window,

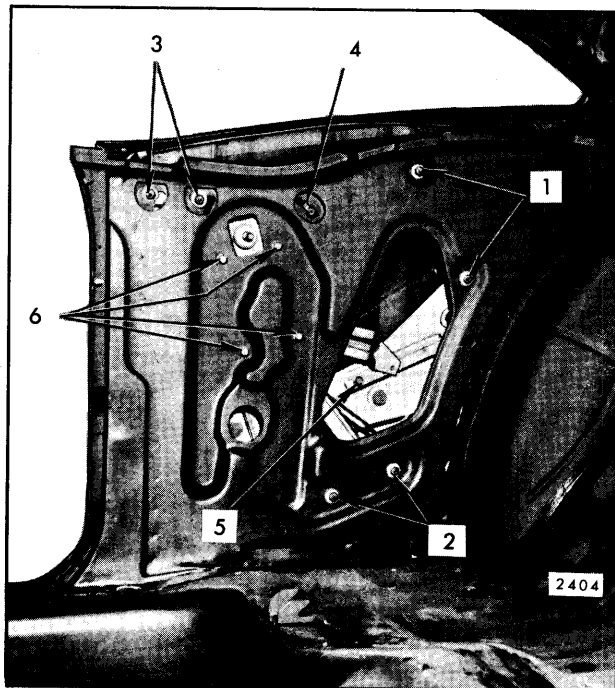

Fig. 7-37—Rear Quarter Hardware - "B-C" Coupe Styles

- |   |   |
|---|---|
| 1. Rear Guide Adjusting Studs and Nuts        | 4. Window Upper Stop                              |
| 2. Front Guide Lower Adjusting Studs and Nuts | 5. Window Lower Stop ("B-C-67" and "C-57" Styles) |
| 3. Front Guide Upper Adjusting Studs and Nuts | 6. Regulator Attaching Bolts                      |

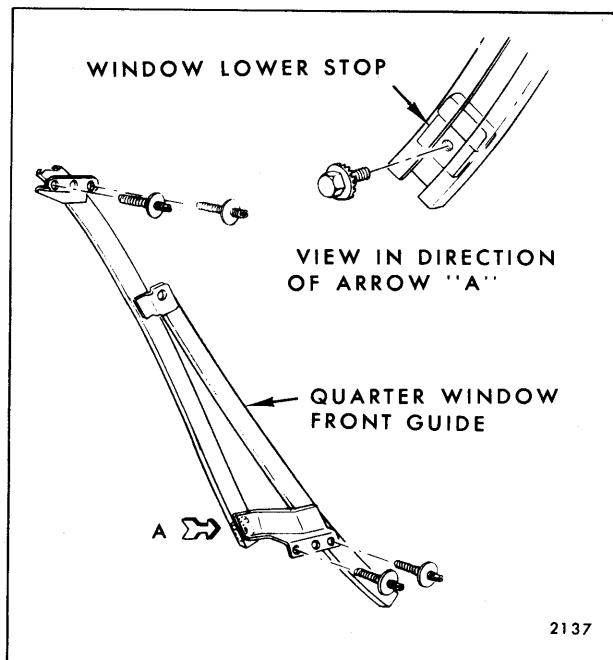

Fig. 7-38—Rear Quarter Window Lower Stop Adjustment - Styles so Equipped

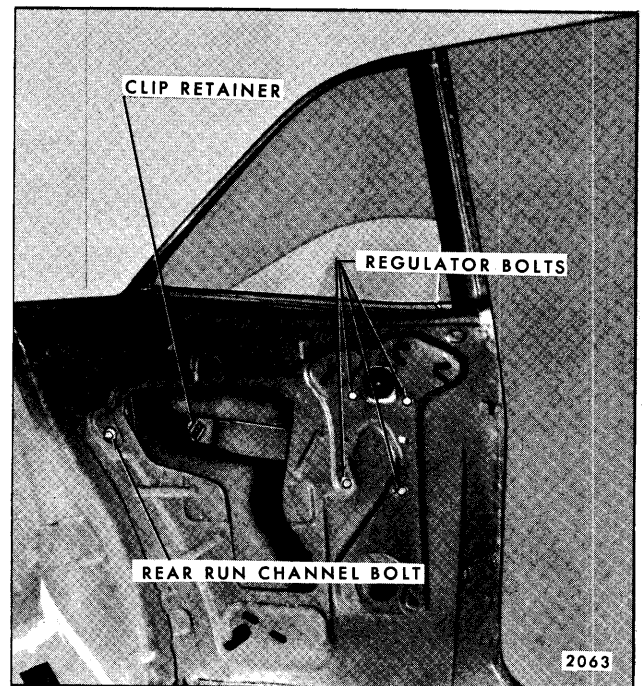

Fig. 7-39—Rear Quarter Hardware Attachment "A-B-X" Closed Styles

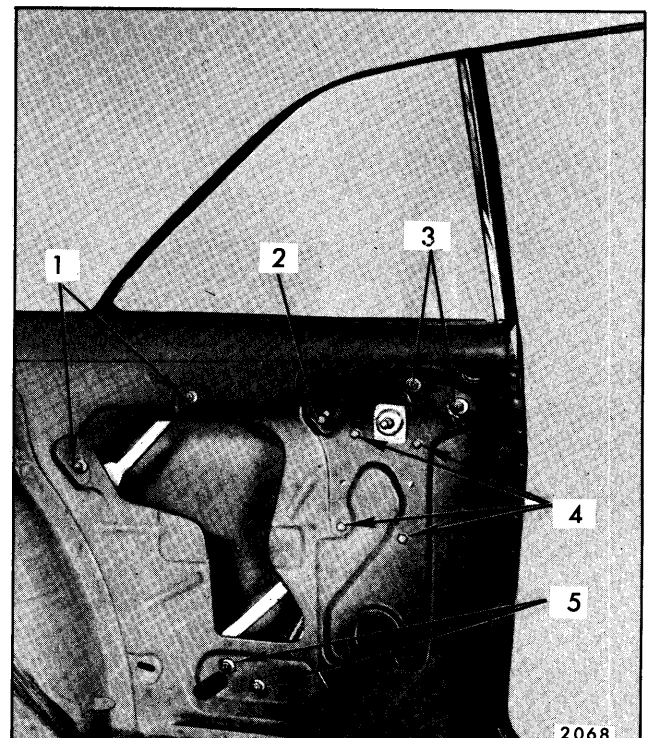

Fig. 7-40—Rear Quarter Hardware - "Z" Styles

- |   |   |
|---|---|
| 1. Rear Guide Adjusting Studs and Nuts        | 4. Regulator Bolts                            |
| 2. Up-Stop Bolts                              | 5. Front Guide Lower Adjusting Studs and Nuts |
| 3. Front Guide Upper Adjusting Studs and Nuts |   |

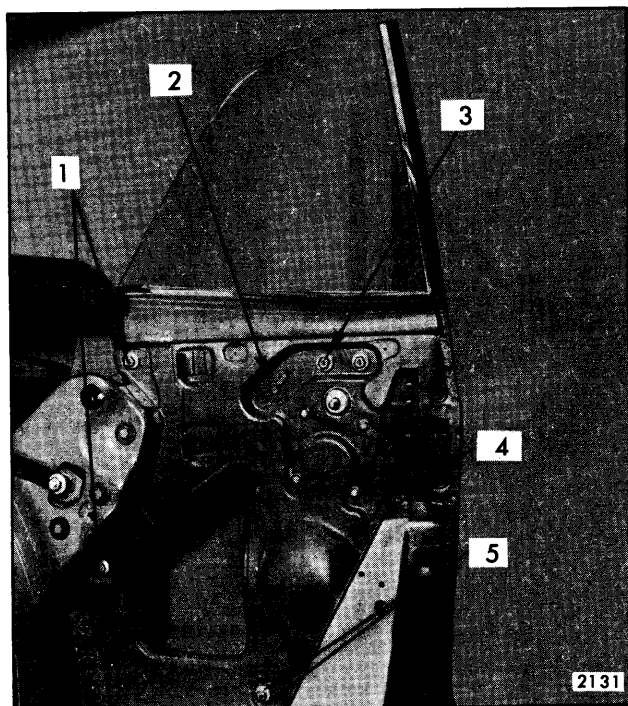

Fig. 7-41—Rear Quarter Hardware - "Z-67" Styles

- |   |   |
|---|---|
| 1. Rear Guide Adjusting Studs and Nuts        | 4. Regulator Bolts                            |
| 2. Up-Stop Bolt                               | 5. Front Guide Lower Adjusting Studs and Nuts |
| 3. Front Guide Upper Adjusting Studs and Nuts |   |

these bolts or stud nuts can be removed and the guide disengaged from glass roller.

3. To install, reverse removal procedure. Adjust guide for proper window operation as specified under "Rear Quarter Window Adjustments".

## REAR QUARTER WINDOW GUIDE ASSEMBLY—"A" Hardtop and Convertible Styles

### Removal and Installation

1. Remove quarter window assembly.

2. Remove lower guide to inner panel attaching nuts.
3. Remove guide through loading hole in quarter inner panel.
4. To install, reverse removal procedure. Adjust guide to proper window operation and alignment as specified under "Rear Quarter Window Adjustments".

## REAR QUARTER WINDOW GUIDE ASSEMBLY—All "F" Styles

### Removal and Installation

1. Remove rear quarter window regulator assembly.
2. Remove rear quarter window assembly.
3. Remove guide attaching nuts (3) and remove guide through large access hole (see Fig. 7-18).
4. To install, reverse removal procedure.

## REAR QUARTER WINDOW GLASS RUN CHANNEL—"E-47" Styles

### Removal and Installation

1. Remove rear quarter trim assembly and inner panel water deflector.
2. Remove lock pillar grille (see Fig. 7-28).
3. Remove run channel rear attachment (on inner panel - see Fig. 7-26) and forward attachment (under lock pillar grille).
4. With rear quarter window fully forward, remove glass run channel in a rearward motion.
5. To install, reverse removal procedure.